

HIFLUX

High Pressure Valves & Fittings

HIFLUX is based on the accumulated precision engineering & technological know-hows, high pressure equipment, required for plant valve, fitting, pressure regulator etc., manufacturing and sells.

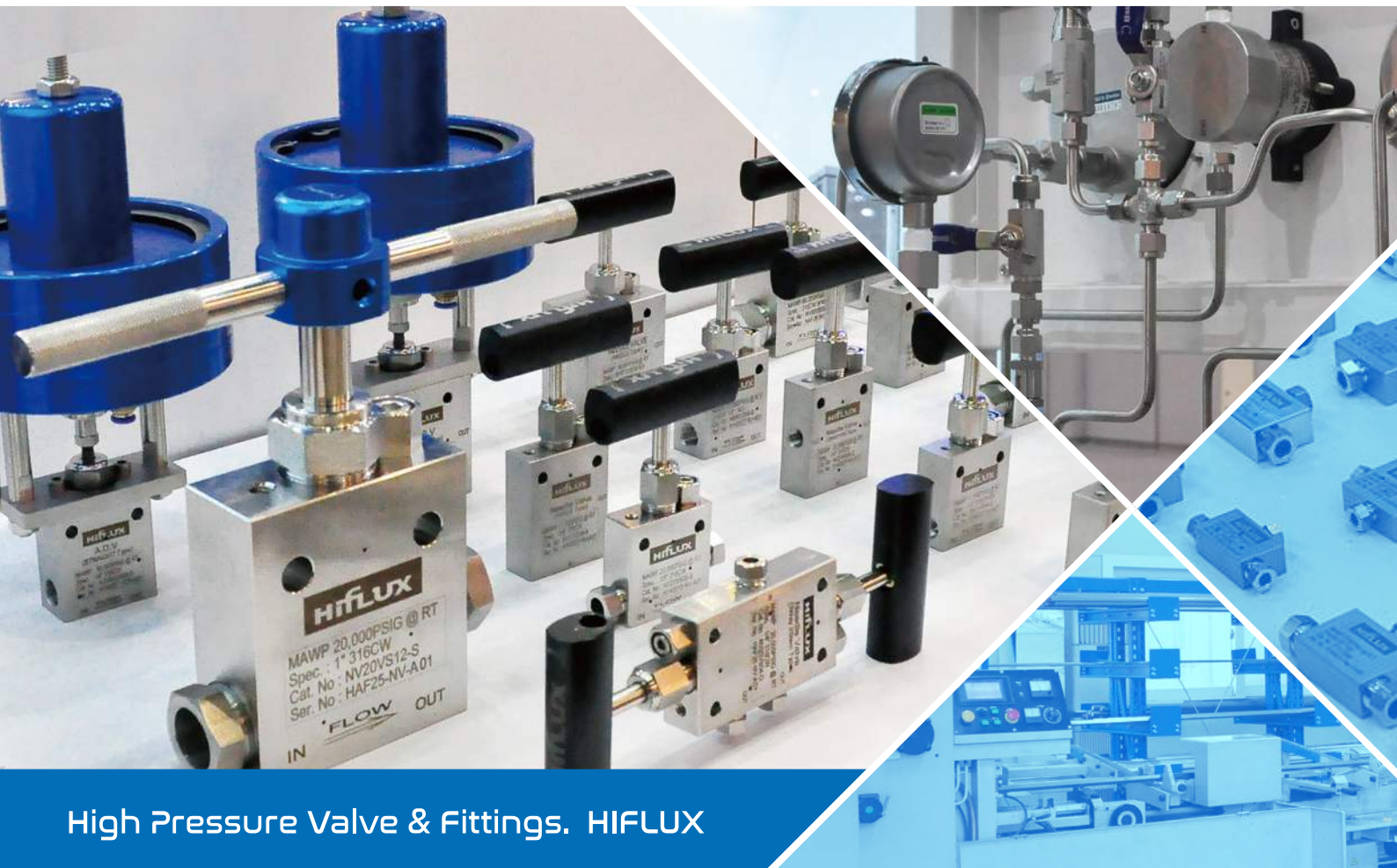

High Pressure Valve & Fittings. HIFLUX

High Service
High Quality
High Performance !!
High Pressure equipment

Based on years of sophisticated engineering technology, Hiflux has been working hard to localize high-temperature, high-pressure industries and open new markets and developed a range of high-pressure products to meet the needs of our customers through constant research and facility investment.

Our products are applied to general pressure to special industry applications which require up to 150,000psig ultra high pressure.

In order to become a global leader in ultra-high pressure, We will do our best to become 'HIFLUX' a company that listens carefully to customers and consistently improves products and service and contributes to enhancing quality and productivity in order to develop and grow together with our customers. Thank you.

CEO
Kim Hyeon-hyo



CONTENTS

Company Overview, Certification

Table of contents

Catalog Numbering System

High Pressure Needle Valve	1
High Pressure Fitting	2
High Pressure Fitting Accessory	3
High Pressure Check Valve	4
High Pressure Ball Valve	5
Air Operated Valve	6
Control Valve	7
Wellhead Gauge Valve	8
Bleed Valve	9
Double Block and Bleed Valve	10
High Temperature Valve	11
Relief Valve (Factory Set)	12
Relief Valve (Field Adjustable)	13
Relief Valve (Proportional Type)	14
Safety Head & Rupture Disc	15
High Pressure Manifold block	16
Thread Lubricant(BLUE LUBE)	17
High Pressure Tube	18
High Pressure Nipple	19
Tooling set	20
Tube Support	21
High Pressure Union & Adapter	22
Regulator	23
Pressure Gauge	24
Lok Fitting&Valve	25
Piping Materials	26

Port Type

Catalog Numbering System

Simply indicate catalog number and specify option or special requirement

NV	60	V	S	06	A
----	----	---	---	----	---

Product Value	Pressure	Type of Components	Material	Tube Size	Options
NV : Needle Valve	03 : 3,000psi	Needle Valve V : Vee Stem R : Regulating Stem	S : Stainless steel 316	02 : 1/8"	Needle Valve Ball Valve Control Valve Air Operated Valve
CV : Check Valve	07 : 7,500psi	Check Valve O : O-Ring Type B : Ball Type	H : Hastelloy	04 : 1/4"	S : Straight Type A : Angle Type
BV : Ball Valve	11 : Sleeve Type <small>Refer to Valve Select</small>	Ball Valve 2 : 2-way 3 : 3-way	HC : Hastelloy C276 wetted part	06 : 3/8"	O : 3way/1on pressure Type T : 3way/2on pressure Type
AOV : Air Operated Valve	20 : 20,000psi	Control Valve Air Operated Valve O : Normal-Open Type C : Normal-Closed Type	IN : Inconel 600	08 : 1/2"	Fitting Accessory AV : Anti-Vibration Type
CON : Control Valve	30 : 30,000psi	Relief Valve FS : Factory Set FA : Field Adjustable PP : Proportional Type	IN625 : Inconel 625	09 : 9/16"	GPR N : Normal Type P : Panel Type
GV : Wellhead Gauge Valve	60 : 60,000psi	Fitting E : Elbow Type T : Tee Type C : Cross Type	IN825 : Inconel 825	12 : 3/4"	
BLV : Bleed Valve	100 : 100,000psi		IN625 : Inconel 625	16 : 1"	
DBBV : Double Block & Bleed Valve	150 : 150,000psi		NI : Nickel 200	15 : 15A	
RV : Relief Valve			TI : Titanium	25 : 25A	
FT : Fitting					
FA : Fitting Accessory					
MF : Manifold Block					
T : Tube					
N : Nipple					
GPR : General Pressure Regulator		Fitting Accessory A : Adapter (20,000psi용) S : Sleeve (저압용) G : Gland R : Collar T : Collet			
HPR : High Pressure Regulator					
BPR : Back Pressure Regulator					
AD : Adapter					
TS : Tube Support					

※ Catalog number can be changed without any notification

Example

- NV60VS06-A : Needle Valve, 60,000psi, Vee Stem, 3/8", Angle Type.
- NV11VS04-O : Needle Valve, 11,500psi, Vee Stem, 1/4", 3Way/1on Pressure Type.
- CON07CS15-S : Control Valve, 7,500psi, Normal-Closed, 15A, Straight Type.
- AOV60CS04-A : Air Operated Valve, 60,000psi, Normal-Closed, 1/4", Angle Type.
- FT60ES06 : Fitting, 60,000psi, Elbow Type, 3/8".
- FA60GS04-AV : Fitting Accessory, 60,000psi, Gland, 1/4", Anti-Vibration Type.

High Pressure Needle Valve

Control and open/close the flow, Manual valve



Needle valve is a hand-operated valve to control the flux of oil or gas according to the degree by which the stem is blocking the passage of oil or gas, or it can be used to open or close the flow of oil or gas. Needle valve is remarkably safe and is highly resistant to corrosion because it was designed and manufactured by taking into account the features of oil and gas and used pressure and at different temperatures. The life of this product has been lengthened by preventing the stem's galling as much as possible.

	Pressure	Tube Size	Cv	Stem Type	Body Type					
					Straight		Angle	3Way/1on	3Way/2on	
※ NVP~ : PT Thread ※ NVN~ : NPT Thread	15,000psi	1/8"		Vee	NVPVS02-S	NVNVS02-S	NVPVS02-A	NVNVS02-A		
				Reg	NVPRS02-S	NVNRS02-S	NVPRS02-A	NVNRS02-A		
		1/4"	Vee	NVPVS04-S	NVNVS04-S	NVPVS04-A	NVNVS04-A			
			Reg	NVPRS04-S	NVNRS04-S	NVPRS04-A	NVNRS04-A			
		3/8"	Vee	NVPVS06-S	NVNVS06-S	NVPVS06-A	NVNVS06-A			
	Reg		NVPRS06-S	NVNRS06-S	NVPRS06-A	NVNRS06-A				
	10,000psi	1/2"	Vee	NVPVS08-S	NVNVS08-S	NVPVS08-A	NVNVS08-A			
			Reg	NVPRS08-S	NVNRS08-S	NVPRS08-A	NVNRS08-A			
		3/4"	Vee	NVPVS12-S	NVNVS12-S	NVPVS12-A	NVNVS12-A			
			Reg	NVPRS12-S	NVNRS12-S	NVPRS12-A	NVNRS12-A			
1"		Vee	NVPVS16-S	NVNVS16-S	NVPVS16-A	NVNVS16-A				
Reg	NVPRS16-S	NVNRS16-S	NVPRS16-A	NVNRS16-A						
Low Pressure	11,000psi	1/8"	0.12	Vee	NV11VS02-S		NV11VS02-A	NV11VS02-O	NV11VS02-T	
	11,500psi	1/4"	0.20	Reg	NV11RS02-S		NV11RS02-A	NV11RS02-O	NV11RS02-T	
				Vee	NV11VS04-S		NV11VS04-A	NV11VS04-O	NV11VS04-T	
	7,500psi	3/8"	0.20	Reg	NV11RS04-S		NV11RS04-A	NV11RS04-O	NV11RS04-T	
				Vee	NV11VS06-S		NV11VS06-A	NV11VS06-O	NV11VS06-T	
	5,500psi	1/2"	1.62	Reg	NV11RS06-S		NV11RS06-A	NV11RS06-O	NV11RS06-T	
				Vee	NV11VS08-S		NV11VS08-A	NV11VS08-O	NV11VS08-T	
				Reg	NV11RS08-S		NV11RS08-A	NV11RS08-O	NV11RS08-T	
Medium Pressure	20,000psi	1/4"	0.31	Vee	NV20VS04-S		NV20VS04-A	NV20VS04-O	NV20VS04-T	
				Reg	NV20RS04-S		NV20RS04-A	NV20RS04-O	NV20RS04-T	
		3/8"	0.75	Vee	NV20VS06-S		NV20VS06-A	NV20VS06-O	NV20VS06-T	
				Reg	NV20RS06-S		NV20RS06-A	NV20RS06-O	NV20RS06-T	
		9/16"	1.30	Vee	NV20VS09-S		NV20VS09-A	NV20VS09-O	NV20VS09-T	
	Reg			NV20RS09-S		NV20RS09-A	NV20RS09-O	NV20RS09-T		
	3/4"	2.50	Vee	NV20VS12-S		NV20VS12-A	NV20VS12-O	NV20VS12-T		
			Reg	NV20RS12-S		NV20RS12-A	NV20RS12-O	NV20RS12-T		
			Vee	NV20VS16-S		NV20VS16-A	NV20VS16-O	NV20VS16-T		
	Reg	NV20RS16-S		NV20RS16-A	NV20RS16-O	NV20RS16-T				
High Pressure	30,000psi	1/8"	0.03	Vee	NV30VS02-S		NV30VS02-A	NV30VS02-O	NV30VS02-T	
				Reg	NV30RS02-S		NV30RS02-A	NV30RS02-O	NV30RS02-T	
		1/4"	0.12	Vee	NV30VS04-S		NV30VS04-A	NV30VS04-O	NV30VS04-T	
				Reg	NV30RS04-S		NV30RS04-A	NV30RS04-O	NV30RS04-T	
		3/8"	0.2	Vee	NV30VS06-S		NV30VS06-A	NV30VS06-O	NV30VS06-T	
	Reg			NV30RS06-S		NV30RS06-A	NV30RS06-O	NV30RS06-T		
	9/16"	0.33	Vee	NV30VS09-S		NV30VS09-A	NV30VS09-O	NV30VS09-T		
			Reg	NV30RS09-S		NV30RS09-A	NV30RS09-O	NV30RS09-T		
			Vee	NV60VS04-S		NV60VS04-A	NV60VS04-O	NV60VS04-T		
	60,000psi	1/4"	0.08	Reg	NV60RS04-S		NV60RS04-A	NV60RS04-O	NV60RS04-T	
Vee				NV60VS06-S		NV60VS06-A	NV60VS06-O	NV60VS06-T		
3/8"		0.09	Reg	NV60RS06-S		NV60RS06-A	NV60RS06-O	NV60RS06-T		
			Vee	NV60VS09-S		NV60VS09-A	NV60VS09-O	NV60VS09-T		
9/16"	0.14	Reg	NV60RS09-S		NV60RS09-A	NV60RS09-O	NV60RS09-T			
Ultra High Pressure	100,000psi	1/4"	0.09	Vee	NV100VS04-S		NV100VS04-A	NV100VS04-O	NV100VS04-T	
				Reg	NV100RS04-S		NV100RS04-A	NV100RS04-O	NV100RS04-T	
	150,000psi	3/8"	0.06	Vee	NV150VS06-S		NV150VS06-A	NV150VS06-O	NV150VS06-T	
Reg	NV150RS06-S		NV150RS06-A	NV150RS06-O	NV150RS06-T					



Features

- 4 pattern Body Type. (Straight, Angle, 3Way/1on, 3Way/2on)
- Prevents galling due to the no-rotation stem.
- Packing designed for reliable sealing.
- Metal to metal seating type to lengthen the life of the seat.
- A valve using stainless steel 316 cold material for excellent corrosion resistant.
- 'Vee' or 'Regulating' stem for flow control and shut-off.

Body Type

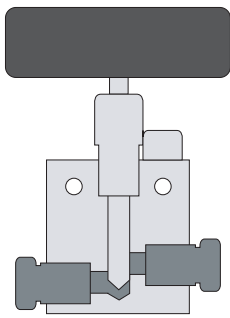

Straight Type

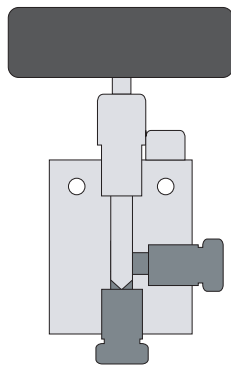

Angle Type

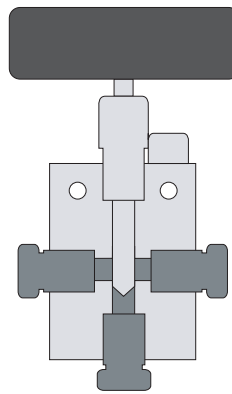

3Way/1on Type

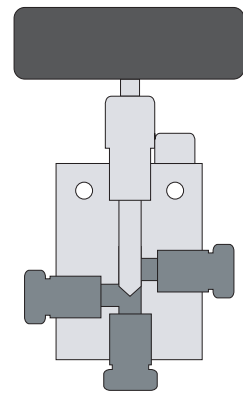

3Way/2on Type

Exploded View & Connection Components

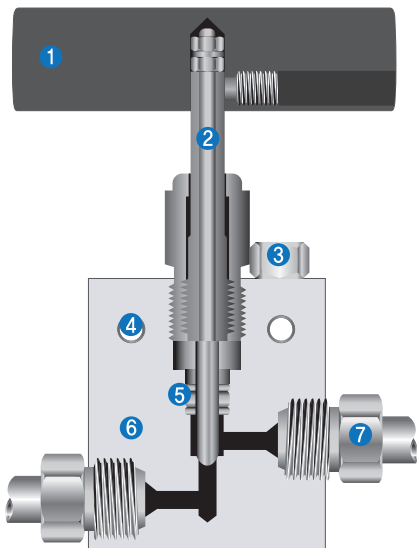

- 1 Valve handle
- 2 Stem
- 3 Stem locking
- 4 Valve fixed hole
- 5 Packing for prevent leakage
- 6 Body block
- 7 Connections

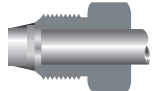
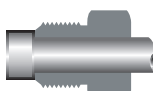
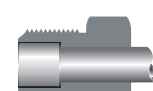
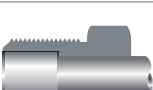
	Low Pressure Sleeve Type 5500, 7500, 11000, 11500psi
	Medium Pressure 20,000psi
	High Pressure 30,000 ~ 60,000psi
	Ultra High Pressure 100,000psi

(Unit:mm)

Straight Type

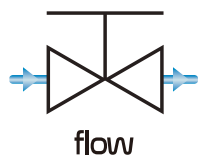
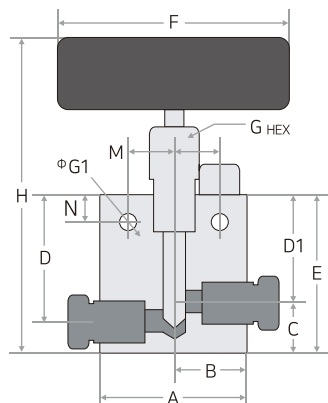

Catalog No.	Stem	Pressure Rating	Port Type	Tube Size	Cv	Orifice Size	Dimensions											Block Thickness								
							A	B	C	D	D1	E	F	G	G1	H	M		N							
NV11VS02-S	Vee	11,000 psi	H1102	1/8"	0.12	2.39	38	19	22	30	23	45	50	13	5	85.6	12.8	8	20							
NV11RS02-S	Reg																									
NV11VS04-S	Vee																									
NV11RS04-S	Reg	11,500 psi	H1104	1/4"	0.20	3.18	50	25	20	40.3	30	50	80	17	6.5	118.2	15.6	9.7	20							
NV11VS06-S	Vee																									
NV11RS06-S	Reg																									
NV11VS08-S	Vee	7,500 psi	H706	3/8"	0.20	3.18	50	25	20.5	40.3	29.5	50	80	17	6.5	119	15.7	9.7	20							
NV11RS08-S	Reg																									
NV11VS08-S	Vee																									
NV11RS08-S	Reg	5,500 psi	H508	1/2"	1.62	7.54	63	31.5	30.5	60.5	44.5	75	100	22	9	151.8	17.5	12.7	25							
NV20VS04-S	Vee																									
NV20RS04-S	Reg																									
NV20VS06-S	Vee	20,000 psi	H2006	3/8"	0.75	5.56	50	25	20	40	30	50	80	17	6.5	117.5	15.7	9.7	20							
NV20RS06-S	Reg																									
NV20VS09-S	Vee																									
NV20RS09-S	Reg	20,000 psi	H2009	9/16"	1.30	7.9	63	31.5	29	60	44	73	100	22	8	145	17.5	12.7	30							
NV20VS12-S	Vee																									
NV20RS12-S	Reg																									
NV20VS16-S	Vee	20,000 psi	H2016	1"	4.40	14.27	105	52.5	49	96	71	120	260	41	14	217.8	31.75	28.5	45							
NV20RS16-S	Reg																									
NV30VS02-S	Vee																									
NV30RS02-S	Reg	30,000 psi	H3002	1/8"	0.03	1.6	38	19	22	30	23	45	50	13	5	82.2	12.75	8	20							
NV30VS04-S	Vee																									
NV30RS04-S	Reg																									
NV30VS06-S	Vee	30,000 psi	H3004	1/4"	0.12	2.4	50	25	21	43	33	54	80	20	6.5	114.9	17	9.7	25							
NV30RS06-S	Reg																									
NV30VS09-S	Vee																									
NV30RS09-S	Reg	30,000 psi	H3006	3/8"	0.2	3.2	50	25	24	43	33	57	80	20	6.5	115.6	17	9.7	25							
NV60VS04-S	Vee																									
NV60RS04-S	Reg																									
NV60VS06-S	Vee	60,000 psi	H6004	1/4"	0.08	2	50	25	21	43	33	54	80	20	6.5	121.4	17	9.7	25							
NV60RS06-S	Reg																									
NV60VS09-S	Vee																									
NV60RS09-S	Reg	60,000 psi	H6006	3/8"	0.09	2	50	25	24	43	33	57	80	20	6.5	124.9	17	9.7	25							
NV100VS04-S	Vee																									
NV100RS04-S	Reg																									
NV150VS06-S	Vee	150,000 psi	H15006	3/8"	0.06	1.59	90	45	30	42	34	64	100	24	7	135	19	12.7	38							
NV150RS06-S	Reg																									

• G : The main top of the hole size • H : Height of the valve is fully closed As all sizes are for reference, they can be changed without any notification.
 • G1 : Hole size of the main positive

Angle Type

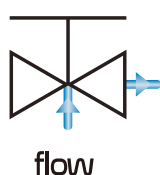
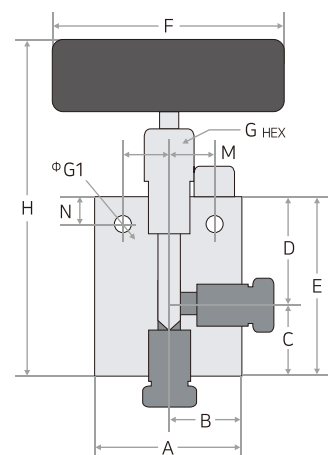

Catalog No.	Stem	Pressure Rating	Port Type	Tube Size	Cv	Orifice Size	Dimensions											Block Thickness									
							A	B	C	D	E	F	G	G1	H	M	N										
NV11VS02-A	Vee	11,000 psi	H1102	1/8"	0.12	2.39	38	19	22	23	45	50	13	5	82	12.8	8	20									
NV11RS02-A	Reg																										
NV11VS04-A	Vee																										
NV11RS04-A	Reg	11,500 psi	H1104	1/4"	0.20	3.18	50	25	32	30	62	80	17	6.5	130.2	15.7	9.7	20									
NV11VS06-A	Vee																										
NV11RS06-A	Reg																										
NV11VS08-A	Vee	7,500 psi	H706	3/8"	0.20	3.18	50	25	32	30	62	80	17	6.5	131	15.7	9.7	20									
NV11RS08-A	Reg																										
NV11VS08-A	Vee																										
NV11RS08-A	Reg	5,500 psi	H508	1/2"	1.62	7.54	63	31.5	41.5	44.5	86	100	22	9	162.8	17.6	12.7	25									
NV20VS04-A	Vee																										
NV20RS04-A	Reg																										
NV20VS06-A	Vee	20,000 psi	H2006	3/8"	0.75	5.56	50	25	32	30	62	80	17	6.5	129.5	15.7	9.7	20									
NV20RS06-A	Reg																										
NV20VS09-A	Vee																										
NV20RS09-A	Reg	20,000 psi	H2009	9/16"	1.30	7.94	63	31.5	41.5	44	85.5	100	22	8	156.6	17.5	12.7	30									
NV30VS02-A	Vee																										
NV30RS02-A	Reg																										
NV30VS04-A	Vee	30,000 psi	H3002	1/8"	0.03	1.6	38	19	22	23	45	50	12.75	5	82.2	12.8	8	20									
NV30RS04-A	Reg																										
NV30VS06-A	Vee																										
NV30RS06-A	Reg	30,000 psi	H3004	1/4"	0.12	2.4	50	25	27.5	33	60.5	80	20	6.5	126.4	17	9.7	25									
NV30VS09-A	Vee																										
NV30RS09-A	Reg																										
NV60VS04-A	Vee	60,000 psi	H6004	1/4"	0.08	2	50	25	27.5	33	60.5	80	20	6.5	127.9	17	9.7	25									
NV60RS04-A	Reg																										
NV60VS06-A	Vee																										
NV60RS06-A	Reg	60,000 psi	H6006	3/8"	0.09	2	50	25	33.5	33	66.5	80	20	6.5	134.4	17	9.7	25									
NV60VS09-A	Vee																										
NV60RS09-A	Reg																										
NV100VS04-A	Vee	100,000 psi	H10004	1/4"	0.09	1.59	67	33.5	30.5	30	63.5	100	24	6.5	130.2	20	9.7	38									
NV100RS04-A	Reg																										
NV150VS06-A	Vee	150,000 psi	H15006	3/8"	0.06	1.59	90	45	32	30	62	100	24	7	130.2	19	12.7	38									
NV150RS06-A	Reg																										

• G : The main top of the hole size • H : Height of the valve is fully closed As all sizes are for reference, they can be changed without any notification.
 • G1 : Hole size of the main positive

3way/1on Type

(Unit:mm)

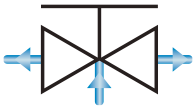
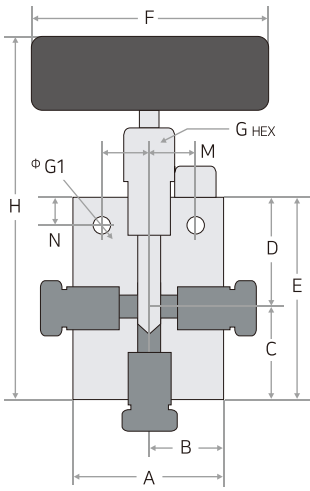

flow

Catalog No.	Stem	Pressure Rating	Port Type	Tube Size	Cv	Orifice Size	Dimensions											Block Thickness
							A	B	C	D	E	F	G	G1	H	M	N	
NV11VS02-O	Vee Reg	11,000 psi	H1102	1/8"	0.12	2.39	38	19	22	23	45	50	13	5	82	12.8	8	20
NV11RS02-O	Vee Reg	11,500 psi	H1104	1/4"	0.20	3.18	50	25	32	30	62	80	17	6.5	130.2	15.6	9.7	20
NV11VS04-O	Vee Reg	7,500 psi	H706	3/8"	0.20	3.18	50	25	32	30	62	80	17	6.5	128.9	15.7	9.7	20
NV11RS04-O	Vee Reg	5,500 psi	H508	1/2"	1.62	7.54	63	31.5	41.5	44.5	86	100	24	9	162.8	17.5	12.7	25
NV20VS04-O	Vee Reg	20,000 psi	H2004	1/4"	0.31	3.18	50	25	32	30	62	80	17	6.5	130.2	15.7	9.7	20
NV20RS04-O	Reg		H2006	3/8"	0.75	5.56	50	25	32	30	62	80	17	6.5	128.9	15.7	9.7	20
NV20VS06-O	Vee Reg		H2009	9/16"	1.30	7.9	63	31.5	42	44	86	100	22	8	156.1	17.5	12.7	30
NV20RS06-O	Reg		H2009	9/16"	1.30	7.9	63	31.5	42	44	86	100	22	8	156.1	17.5	12.7	30
NV30VS02-O	Vee Reg	30,000 psi	H3002	1/8"	0.03	1.6	38	19	22	23	45	50	13	5	82.2	12.8	8	20
NV30RS02-O	Reg		H3004	1/4"	0.12	2.4	50	25	33.5	28.5	62	80	20	6.5	126.4	17.2	9.7	25
NV30VS04-O	Vee Reg		H3006	3/8"	0.2	3.2	50	25	33.5	28.5	62	80	20	6.5	126.4	17.2	9.7	25
NV30RS04-O	Reg		H3009	9/16"	0.33	3.2	67	33.5	33.5	28.5	62	80	20	6.5	130.3	17.2	9.7	38
NV60VS04-O	Vee Reg	60,000 psi	H6004	1/4"	0.08	2	50	25	27.5	33	60.5	80	20	6.5	127.9	17	9.7	25
NV60RS04-O	Reg		H6006	3/8"	0.09	2	50	25	34	33	67	80	20	6.5	137.4	17	9.7	25
NV60VS06-O	Vee Reg		H6009	9/16"	0.14	2	67	33.5	38.5	33	71.5	80	20	6.5	134.4	17	9.7	38
NV60RS06-O	Reg		H6009	9/16"	0.14	2	67	33.5	38.5	33	71.5	80	20	6.5	134.4	17	9.7	38
NV100VS04-O	Vee Reg	100,000 psi	H10004	1/4"	0.09	1.59	67	33.5	32	30	62	100	24	6.5	130.2	20	9.7	38
NV100RS04-O	Reg	150,000 psi	H15006	3/8"	0.06	1.59	90	45	32	30	62	100	24	7	130.2	19	12.7	38
NV150VS06-O	Vee Reg		H15006	3/8"	0.06	1.59	90	45	32	30	62	100	24	7	130.2	19	12.7	38
NV150RS06-O	Reg	H15006	3/8"	0.06	1.59	90	45	32	30	62	100	24	7	130.2	19	12.7	38	

• G : The main top of the hole size • H : Height of the valve is fully closed • As all sizes are for reference, they can be changed without any notification.
 • G1 : Hole size of the main positive

3way/2on Type

(Unit:mm)

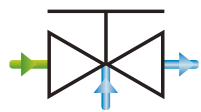
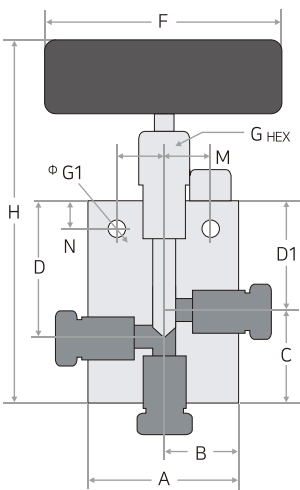

flow

Catalog No.	Stem	Pressure Rating	Port Type	Tube Size	Cv	Orifice Size	Dimensions											Block Thickness	
							A	B	C	D	D1	E	F	G	G1	H	M		N
NV11VS02-T	Vee Reg	11,000 psi	H1102	1/8"	0.12	2.39	38	19	22	30	23	45	50	13	5	82	12.8	8	20
NV11RS02-T	Vee Reg	11,500 psi	H1104	1/4"	0.20	3.18	50	25	36.5	40	30	66.5	80	17	6.5	134.8	15.7	9.7	20
NV11VS04-T	Vee Reg	7,500 psi	H706	3/8"	0.20	3.18	50	25	36.5	41	30	66.5	80	17	6.5	133.3	15.7	9.7	20
NV11RS04-T	Vee Reg	5,500 psi	H508	1/2"	1.62	7.54	63	31.5	47.5	60.5	44.5	92	100	24	9	168.8	17.5	12.7	25
NV11VS06-T	Vee Reg	20,000 psi	H2004	1/4"	0.31	3.18	50	25	36.5	40	30	66.5	80	17	6.5	134.7	15.7	9.7	20
NV11RS06-T	Reg		H2006	3/8"	0.75	5.56	50	25	36.5	40	30	66.5	80	17	6.5	133.3	15.7	9.7	20
NV20VS04-T	Vee Reg		H2009	9/16"	1.30	7.9	63	31.5	48	60	44	92	100	22	8	159.9	17.5	12.7	30
NV20RS04-T	Reg		H2009	9/16"	1.30	7.9	63	31.5	48	60	44	92	100	22	8	159.9	17.5	12.7	30
NV30VS02-T	Vee Reg	30,000 psi	H3002	1/8"	0.03	1.6	38	19	22	30	23	45	50	13	5	87.2	12.8	8	20
NV30RS02-T	Reg		H3004	1/4"	0.12	2.4	50	25	33.5	38	28.5	62	80	20	6.5	126.4	17.2	9.7	25
NV30VS04-T	Vee Reg		H3006	3/8"	0.2	3.2	50	25	38.5	43	33	71.5	80	20	6.5	127.9	17	9.7	25
NV30RS04-T	Reg		H3009	9/16"	0.33	3.2	67	33.5	44	39.5	33	77	80	20	6.5	141.3	17.2	9.7	38
NV60VS04-T	Vee Reg	60,000 psi	H6004	1/4"	0.08	2	50	25	27.2	43	33	60.5	80	20	6.5	127.9	17	9.7	25
NV60RS04-T	Reg		H6006	3/8"	0.09	2	50	25	38.5	43	33	71.5	80	20	6.5	138.9	17	9.7	25
NV60VS06-T	Vee Reg		H6009	9/16"	0.14	2	67	33.5	45.5	43	33	77	80	20	6.5	144.4	17	9.7	38
NV60RS06-T	Reg		H6009	9/16"	0.14	2	67	33.5	45.5	43	33	77	80	20	6.5	144.4	17	9.7	38
NV100VS04-T	Vee Reg	100,000 psi	H10004	1/4"	0.09	1.59	67	33.5	36.5	41	30	66.5	100	24	6.5	134.7	20	9.7	38
NV100RS04-T	Reg	150,000 psi	H15006	3/8"	0.06	1.59	90	45	36.5	41	30	66.5	100	24	7	134.7	19	12.7	38
NV150VS06-T	Vee Reg		H15006	3/8"	0.06	1.59	90	45	36.5	41	30	66.5	100	24	7	134.7	19	12.7	38
NV150RS06-T	Reg	H15006	3/8"	0.06	1.59	90	45	36.5	41	30	66.5	100	24	7	134.7	19	12.7	38	

• G : The main top of the hole size • H : Height of the valve is fully closed • As all sizes are for reference, they can be changed without any notification.
 • G1 : Hole size of the main positive

Needle Valve - 3/4 · 1 inch

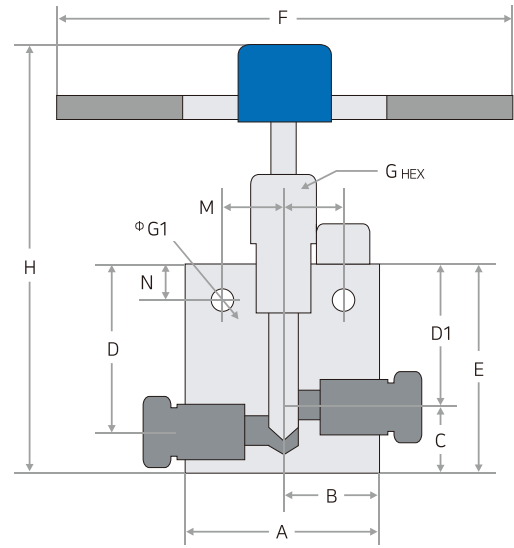

(Unit:mm)

Catalog No.	Stem	Pressure Rating	Port Type	Tube Size	Cv	Orifice Size	Dimensions											Block Thickness	
							A	B	C	D	D1	E	F	G	G1	H	M		N
NV20VS12-S	Vee	20,000 psi	H2012	3/4"	2.50	11.13	76	38	38	76	57	95	253	30	10	177.8	23	15.8	35
NV20RS12-S	Reg																		
NV20VS16-S	Vee		H2016	1"	4.40	14.27	105	52.5	49	96	71	120	260	41	14	217.8	31.75	28.5	45
NV20RS16-S	Reg																		

- G : The main top of the hole size
- H : Height of the valve is fully closed
- G1 : Hole size of the main positive

As all sizes are for reference, they can be changed without any notification.

Needle Valve - Panel Type



Recommend thickness for panel : 2~5mm.

Panel type can be applied only 1/4, 3/8" and 9/16" inch.

3way/2stem Needle Valve

Valves that allow adjustment of each of two outlets with one inlet

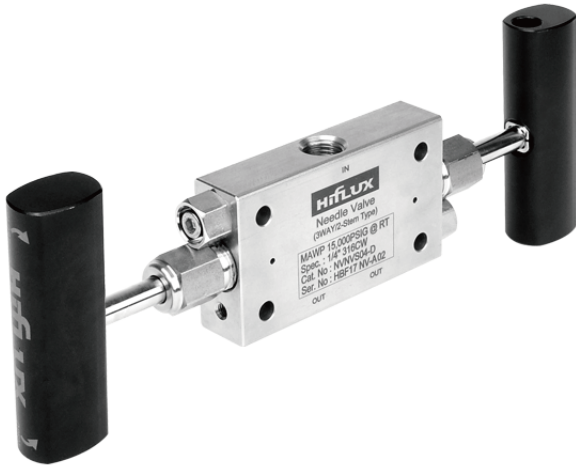

3way 2stem needle valve is slightly modified from the basic needle valve. It consists of two outlet ports and one inlet port and can be turned on or off each outlet port. It is installed two lines and uses one line. It can be used for by-pass during maintenance and equipment can be working continuously. It is divided by pressure and port size and can be used according to customer requirement specifications.

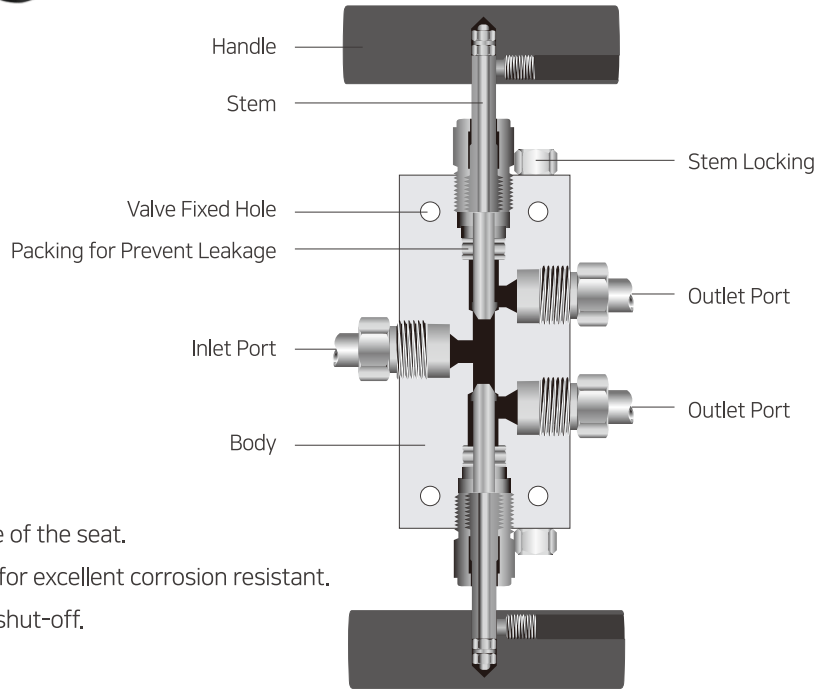

Features

- Prevents galling due to the no-rotation stem.
- Packing designed for reliable sealing.
- Metal to metal seating type to lengthen the life of the seat.
- A valve using stainless steel 316 cold material for excellent corrosion resistant.
- 'Vee' or 'Regulating' stem for flow control and shut-off.

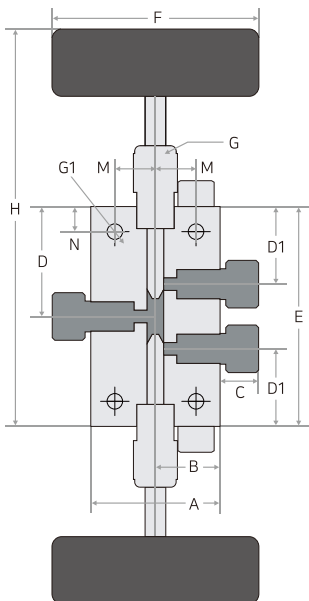

(Unit:mm)

Catalog No.	Stem	Pressure Rating	Port Type	Tube Size	Orifice Size	Dimensions													Block Thickness
						A	B	C	D	D1	E	F	G	G1	H	M	N		
NV11VS02-D	Vee	11,500 psi	H1102	1/8"	2.39	38	19	11.7	28.5	20.5	57	50	13	5	94	12.8	8	20	
NV11RS02-D	Reg																		
NV11VS04-D	Vee		H1104	1/4"	3.18	51	25.5	12	43	27.7	86	80	17	6	154.2	15.6	9.7	20	
NV11RS04-D	Reg																		
NV11VS06-D	Vee		H706	3/8"	3.18	51	25.5	14.3	43	27.7	86	80	17	6	152.9	15.7	9.7	20	
NV11RS06-D	Reg																		
NV11VS08-D	Vee	H508	1/2"	7.54	63	31.5	19.6	43	27.7	86	100	24	9	162.8	17.5	12.7	25		
NV11RS08-D	Reg																		
NV20VS04-D	Vee	20,000 psi	H2004	1/4"	3.2	50	25	13.8	42.5	30	85	80	17	6	153.2	15.7	9.7	20	
NV20RS04-D	Reg																		
NV20VS06-D	Vee		H2006	3/8"	5.5	50	25	14.2	42.5	30	85	80	17	6	151.9	15.7	9.7	20	
NV20RS06-D	Reg																		
NV20VS09-D	Vee		H2009	9/16"	7.9	64	32	16	65	44.5	130	80	22	8	200.1	15.7	12.7	25	
NV20RS09-D	Reg																		
NV20VS12-D	Vee		H2012	3/4"	11.1	76	38	18	82.5	57	165	260	30	10	187.8	46	15.8	35	
NV20RS12-D	Reg																		
NV20VS16-D	Vee		H2016	1"	14.3	105	52.5	22.1	95.5	71	191	260	41	14	290.8	63.5	28.5	45	
NV20RS16-D	Reg																		
NV30VS04-D	Vee	30,000 psi	H3004	1/4"	2.4	51	25.5	9	43.5	33	87	80	20	6	147.9	17	9.7	25	
NV30RS04-D	Reg																		
NV30VS06-D	Vee		H3006	3/8"	3.2	51	25.5	14	47.5	33	95	80	20	6	153.6	17	9.7	25	
NV30RS06-D	Reg																		
NV30VS09-D	Vee	H3009	9/16"	3.2	67	33.5	21	52.5	33	105	80	20	6	173.3	17	9.7	38		
NV30RS09-D	Reg																		
NV60VS04-D	Vee	60,000 psi	H6004	1/4"	2	51	25.5	12.8	43.5	33	87	80	20	6	154.4	17	9.7	25	
NV60RS04-D	Reg																		
NV60VS06-D	Vee		H6006	3/8"	2	51	25.5	18.6	47.5	33	95	80	20	6	162.9	17	9.7	25	
NV60RS06-D	Reg																		
NV60VS09-D	Vee	H6009	9/16"	2	67	33.5	21.7	52.5	33	105	80	20	6	170.4	17	9.7	38		
NV60RS09-D	Reg																		

- G : The main top of the hole size
- G1 : Hole size of the main positive
- H : Height of the valve is fully closed

As all sizes are for reference, they can be changed without any notification.

High Pressure Fitting

Fitting & accessory used simple structure design and wear resistant material for high pressure connection



Features

- 3 patterns body types. (Elbow, Tee, Cross type).
- A valve using stainless steel 316 cold material for excellent corrosion resistant.
- Cone and thread connection is strong in relation to water leaks even when using gas and liquid.
- The operation temperature ranges from -423°F (-252°C) to 1200°F (649°C).
- Fitting is used for connecting tubes at high pressure and has a high-flow property and diverse sized orifice according to pressure.
- Various orifice sizes with 150,000psi maximum pressure.

Pressure Rating	Tube Size	Fitting			Fitting Accessory		
		Elbow	Tee	Cross	Gland	Sleeve	Collar
11,000psi	1/8"	FT11ES02	FT11TS02	FT11CS02	FA11GS02	FA11SS02	
11,500psi	1/4"	FT11ES04	FT11TS04	FT11CS04	FA11GS04	FA11SS04	
7,500psi	3/8"	FT11ES06	FT11TS06	FT11CS06	FA11GS06	FA11SS06	
5,500psi	1/2"	FT11ES08	FT11TS08	FT11CS08	FA11GS08	FA11SS08	
20,000psi	1/4"	FT20ES04	FT20TS04	FT20CS04	FA20GS04		FA20RS04
	3/8"	FT20ES06	FT20TS06	FT20CS06	FA20GS06		FA20RS06
	9/16"	FT20ES09	FT20TS09	FT20CS09	FA20GS09		FA20RS09
	3/4"	FT20ES12	FT20TS12	FT20CS12	FA20GS12		FA20RS12
	1"	FT20ES16	FT20TS16	FT20CS16	FA20GS16		FA20RS16
30,000psi	1/8"	FT30ES02	FT30TS02	FT30CS02	FA30GS02		FA30RS02
	1"	FT30ES16	FT30TS16	FT30CS16	FA30GS16		FA30RS16
60,000psi	1/4"	FT60ES04	FT60TS04	FT60CS04	FA60GS04		FA60RS04
	3/8"	FT60ES06	FT60TS06	FT60CS06	FA60GS06		FA60RS06
	9/16"	FT60ES09	FT60TS09	FT60CS09	FA60GS09		FA60RS09
100,000psi	1/4"	FT100ES04	FT100TS04	FT100CS04	FA100GS04		FA100RS04
150,000psi	3/8"	FT150ES06	FT150TS06	FT150CS06	FA150GS06		FA150RS06
Anti-Vibration		Elbow	Tee	Cross	Gland	Collar	Collet
20,000psi	1/4"	FT20ES04-AV	FT20TS04-AV	FT20CS04-AV	FA20GS04-AV	FA20RS04-AV	FA20TS04-AV
	3/8"	FT20ES06-AV	FT20TS06-AV	FT20CS06-AV	FA20GS06-AV	FA20RS06-AV	FA20TS06-AV
	9/16"	FT20ES09-AV	FT20TS09-AV	FT20CS09-AV	FA20GS09-AV	FA20RS09-AV	FA20TS09-AV
	3/4"	FT20ES12-AV	FT20TS12-AV	FT20CS12-AV	FA20GS12-AV	FA20RS12-AV	FA20TS12-AV
	1"	FT20ES16-AV	FT20TS16-AV	FT20CS16-AV	FA20GS16-AV	FA20RS16-AV	FA20TS16-AV
60,000psi	1/4"	FT60ES04-AV	FT60TS04-AV	FT60CS04-AV	FA60GS04-AV	FA60RS04-AV	FA60TS04-AV
	3/8"	FT60ES06-AV	FT60TS06-AV	FT60CS06-AV	FA60GS06-AV	FA60RS06-AV	FA60TS06-AV
	9/16"	FT60ES09-AV	FT60TS09-AV	FT60CS09-AV	FA60GS09-AV	FA60RS09-AV	FA60TS09-AV

(Unit:mm)

Elbow Type

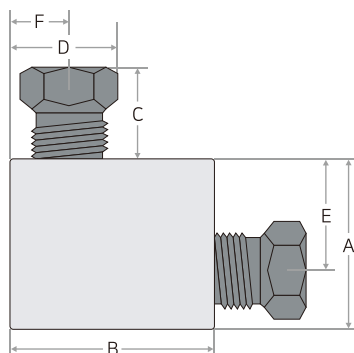

Catalog No.	Pressure Rating	Port Type	Tube Size	Orifice Size	Dimensions						Block Thickness
					A	B	C	D(HEX)	E	F	
FT11ES02	11,000 psi	H1102	1/8"	1.4	25	25	12.2	12	19	7	15.5
FT11ES04	11,500 psi	H1104	1/4"	4	35	35	12.2	16	25	10	20
FT11ES06	7,500 psi	H706	3/8"	5.5	35	35	14	19	25	10	20
FT11ES08	5,500 psi	H508	1/2"	8.5	45	45	16.3	25.4	31.5	13.5	25
FT20ES04	20,000 psi	H2004	1/4"	2.8	25	30	13.8	12	17.5	8	16
FT20ES06		H2006	3/8"	5.2	35	35	14.2	16	25	10	20
FT20ES09		H2009	9/16"	9.1	45	45	19.3	22	31.5	13.5	25
FT20ES12		H2012	3/4"	13	57	57	19.3	28	38	19	35
FT20ES16		H2016	1"	17.5	76	76	21.7	35	52.5	23.5	45
FT30ES02	30,000 psi	H3002	1/8"	1.16	28	28	8.7	13	19	9	20
FT30ES16		H3016	1"	11.1	76	76	21.7	35	52.5	23.5	45
FT60ES04	60,000 psi	H6004	1/4"	2.4	35	35	12.83	16	22.5	12.5	25
FT60ES06		H6006	3/8"	3.2	38	45	18.6	20	25	13.5	25
FT60ES09		H6009	9/16"	4.8	47.5	67	21.66	30	28.5	19	38
FT100ES04	100,000 psi	H10004	1/4"	2.4	44.5	44.5	14.4	16	31.5	13	25
FT150ES06	150,000 psi	H15006	3/8"	2.4	67	67	18.3	20	45	22	38

Tee Type

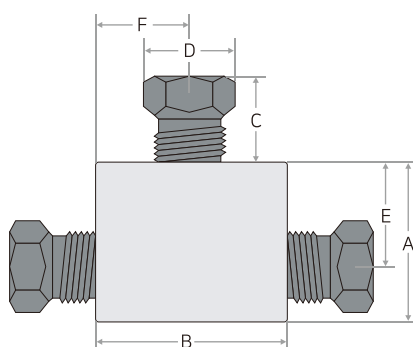

(Unit:mm)

Catalog No.	Pressure Rating	Port Type	Tube Size	Orifice Size	Dimensions						Block Thickness
					A	B	C	D(HEX)	E	F	
FT11TS02	11,000 psi	H1102	1/8"	1.4	25	38	12.2	12	19	19	15.5
FT11TS04	11,500 psi	H1104	1/4"	4	35	50	12.2	16	25	25	20
FT11TS06	7,500 psi	H706	3/8"	5.5	35	50	14	19	25	25	20
FT11TS08	5,500 psi	H508	1/2"	8.5	45	63	16.3	25.4	31.5	31.5	25
FT20TS04	20,000 psi	H2004	1/4"	2.8	25	44	13.8	12	17.5	22	16
FT20TS06		H2006	3/8"	5.2	35	50	14.2	16	25	25	20
FT20TS09		H2009	9/16"	9.1	45	63	19.3	22	31.5	31.5	25
FT20TS12		H2012	3/4"	13	57	76	19.3	28	38	38	35
FT20TS16		H2016	1"	17.5	76	105	21.7	35	52.5	52.5	45
FT30TS02	30,000 psi	H3002	1/8"	1.16	38	28	8.7	13	19	19	20
FT30TS16		H3016	1"	11.1	76	105	21.7	35	52.5	52.5	45
FT60TS04	60,000 psi	H6004	1/4"	2.4	35	50	12.83	16	22.5	25	25
FT60TS06		H6006	3/8"	3.2	40	50	18.6	20	27	25	25
FT60TS09		H6009	9/16"	4.8	54	67	21.66	30	35	33.25	38
FT100TS04	100,000 psi	H10004	1/4"	2.4	63	44.5	14.4	16	31.5	31.5	25
FT150TS06	150,000 psi	H15006	3/8"	2.4	90	67	18.3	20	45	45	38

Cross Type

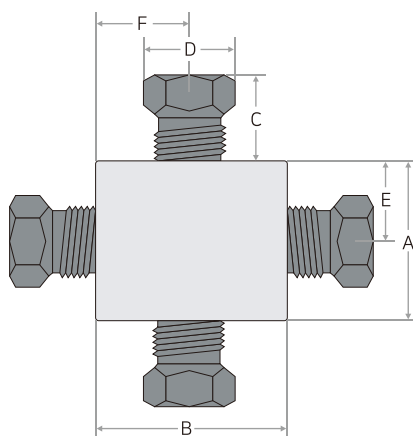

(Unit:mm)

Catalog No.	Pressure Rating	Port Type	Tube Size	Orifice Size	Dimensions						Block Thickness
					A	B	C	D(HEX)	E	F	
FT11CS02	11,000 psi	H1102	1/8"	1.4	38	38	12.2	12	19	19	15.5
FT11CS04	11,500 psi	H1104	1/4"	4	50	50	12.2	16	25	25	20
FT11CS06	7,500 psi	H706	3/8"	5.5	50	50	14	19	25	25	20
FT11CS08	5,500 psi	H508	1/2"	8.5	63	63	16.3	25.4	31.5	31.5	25
FT20CS04	20,000 psi	H2004	1/4"	2.8	35	44	13.8	12	17.5	22	16
FT20CS06		H2006	3/8"	5.2	50	50	14.2	16	25	25	20
FT20CS09		H2009	9/16"	9.1	63	63	19.3	22	31.5	31.5	25
FT20CS12		H2012	3/4"	13	76	76	19.3	28	38	38	35
FT20CS16		H2016	1"	17.5	105	105	21.7	35	52.5	52.5	45
FT30CS02	30,000 psi	H3002	1/8"	1.16	38	38	8.7	13	19	19	20
FT30CS16		H3016	1"	11.1	105	105	21.7	35	52.5	52.5	45
FT60CS04	60,000 psi	H6004	1/4"	2.4	38	50	12.83	16	19	25	25
FT60CS06		H6006	3/8"	3.2	50	54	18.6	20	25	27	25
FT60CS09		H6009	9/16"	4.8	67	70	21.66	30	33.25	35	38
FT100CS04	100,000 psi	H10004	1/4"	2.4	63	63	14.4	16	31.5	31.5	25
FT150CS06	150,000 psi	H15006	3/8"	2.4	90	90	18.3	20	45	45	38

- As all sizes are for reference, they can be changed without any notification.
- Fitting is block, gland and collar(or sleeve) form a set.

High Pressure Fitting Accessory

Fitting & accessory used simple structure design and wear resistant material for high pressure connection

Gland

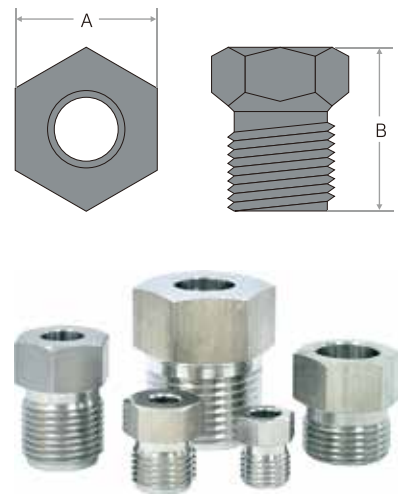

(Unit:mm)

Catalog No.				Pressure Rating	Port Type	Tube Size	Dimensions	
Gland	Sleeve	Collar	Plug				A	B
FA11GS02	FA11SS02			11,000 psi	H1102	1/8"	12	14.5
FA11GS04	FA11SS04			11,500 psi	H1104	1/4"	16	16
FA11GS06	FA11SS06			7,500 psi	H706	3/8"	17	19
FA11GS08	FA11SS08			5,500 psi	H508	1/2"	25.4	24
FA20GS04		FA20RS04	FA20PS04	20,000 psi	H2004	1/4"	12	16
FA20GS06		FA20RS06	FA20PS06		H2006	3/8"	16	20
FA20GS09		FA20RS09	FA20PS09		H2009	9/16"	22	27
FA20GS12		FA20RS12	FA20PS12		H2012	3/4"	27	28
FA20GS16		FA20RS16	FA20PS16		H2016	1"	36	38
FA30GS02		FA30RS02	FA30PS02	30,000 psi	H3002	1/8"	13	18
FA30GS16		FA30RS16	FA30PS16		H3016	1"	36	38
FA60GS04		FA60RS04	FA60PS04	60,000 psi	H6004	1/4"	16	20
FA60GS06		FA60RS06	FA60PS06		H6006	3/8"	20	30
FA60GS09		FA60RS09	FA60PS09		H6009	9/16"	30	38
FA100GS04		FA100RS04	FA100PS04	100,000 psi	H10004	1/4"	16	30
FA150GS06		FA150RS06	FA150PS06	150,000 psi	H15006	3/8"	20	30

As all sizes are for reference, they can be changed without any notification.

Sleeve



Tubing Gland Sleeve	Nipple Gland Collar	Nipple Gland Collar
11,500psi	20,000psi	30,000 ~ 60,000psi

Collar



Anti-Vibration Type

(Unit:mm)

Catalog No.				Pressure Rating	Port Type	Tube Size	Dimensions	
Anti - Set	Gland	Sleeve	Collar				A	B
FA20AS04	FA20GS04-AV	FA20RS04	FA20TS04-AV	20,000 psi	H2004	1/4"	12	16
FA20AS06	FA20GS06-AV	FA20RS06	FA20TS06-AV		H2006	3/8"	16	20
FA20AS09	FA20GS09-AV	FA20RS09	FA20TS09-AV		H2009	9/16"	22	27
FA20AS12	FA20GS12-AV	FA20RS12	FA20TS12-AV		H2012	3/4"	27	28
FA20AS16	FA20GS16-AV	FA20RS16	FA20TS16-AV		H2016	1"	36	38
FA60AS04	FA60GS04-AV	FA60RS04	FA60TS04-AV	60,000 psi	H6004	1/4"	16	20
FA60AS06	FA60GS06-AV	FA60RS06	FA60TS06-AV		H6006	3/8"	20	30
FA60AS09	FA60GS09-AV	FA60RS09	FA60TS09-AV		H6009	9/16"	30	38

As all sizes are for reference, they can be changed without any notification.

Collet



20,000psi					
	Gland	Collet	Adapter	Collar	Nipple
60,000psi					
	Gland	Collet	Collar	Nipple	

High Pressure Check Valve

Gas or liquid prevents flowing backward



Check valve, a valve to prevent the reverse flow of liquid (gas), is designed to block the flow in one direction and to promote the flow in the opposite direction. A ball or o-ring is used for the sealing purposes to prevent the reverse flow for certain.

Both gas and liquid can be used.

Features

- 2 patterns sealing types. (O-Ring Type, Ball Type)
- 2~90µm's 2 patterns sealing types filter element. (Cup Type, Plate Type)
- O-Ring for easy replacement and ball replacement type check valve.
- Excellent corrosion resistant.
- A valve using stainless steel 316 cold material for preventing reverse flow.
- A valve that facilitates one-directional movement by blocking the reverse flow of gas or liquid.
- Cone and thread connection to prevent gas or liquid leaking.

		Check Valve		Filter	
Pressure	Tube Size	Sealing Type		Element Type	
		O-Ring	Ball	Cup	Plate
11,000psi	1/8"	CV11OS02	CV11BS02	FL11CS02	FL11PS02
11,500psi	1/4"	CV11OS04	CV11BS04	FL11CS04	FL11PS04
7,500psi	3/8"	CV11OS06	CV11BS06	FL11CS06	FL11PS06
5,500psi	1/2"	CV11OS08	CV11BS08	FL11CS08	FL11PS08
20,000psi	1/4"	CV20OS04	CV20BS04	FL20CS04	FL20PS04
	3/8"	CV20OS06	CV20BS06	FL20CS06	FL20PS06
	9/16"	CV20OS09	CV20BS09	FL20CS09	FL20PS09
	3/4"	CV20OS12	CV20BS12	FL20CS12	FL20PS12
	1"	CV20OS16	CV20BS16	FL20CS16	FL20PS16
30,000psi	1/8"	CV30OS02	CV30BS02	FL30CS02	FL30PS02
	1"	CV30OS16	CV30BS16	FL30CS16	FL30PS16
60,000psi	1/4"	CV60OS04	CV60BS04	FL60CS04	FL60PS04
	3/8"	CV60OS06	CV60BS06	FL60CS06	FL60PS06
	9/16"	CV60OS09	CV60BS09	FL60CS09	FL60PS09

O-Ring Type

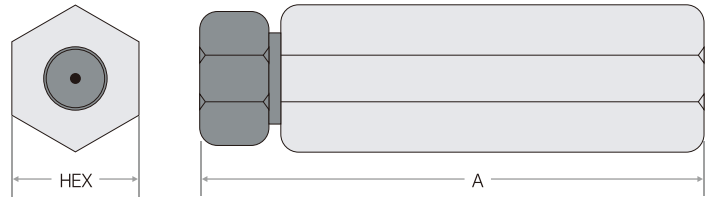

(Unit:mm)

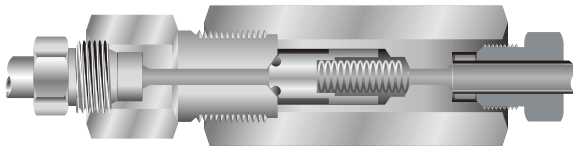

Ball Type

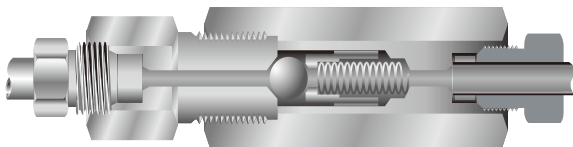
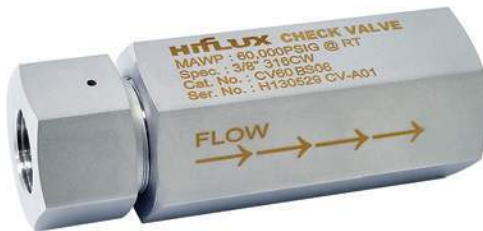

Filter Element (Cup type)

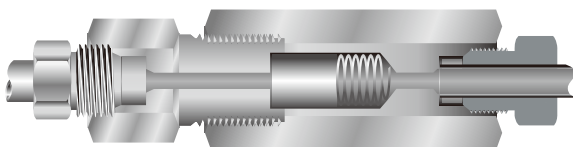

Catalog No.	Pressure Rating	Tube Size	Orifice Size	Dimensions	
				HEX	A
CV110S02	11,000 psi	1/8"	1.4	22	68
CV11BS02					
CV110S04	11,500 psi	1/4"	3.2	25.4	81
CV11BS04					
CV110S06	7,500 psi	3/8"	5	35	93
CV11BS06					
CV110S08	5,500 psi	1/2"	8.35	41	108
CV11BS08					
CV200S04	20,000 psi	1/4"	2.8	25	77
CV20BS04		3/8"	5.2	25	91
CV200S06					
CV20BS06		9/16"	5	35	107
CV200S09					
CV20BS09		3/4"	5	41	131
CV200S12					
CV20BS12		1"	6	55	165
CV200S16					
CV20BS16					
CV300S02	30,000 psi	1/8"	1.2	20	66
CV30BS02		1"			
CV300S16					
CV30BS16					
CV600S04	60,000 psi	1/4"	2.4	32	85
CV60BS04		3/8"	3.2	36	100
CV600S06					
CV60BS06		9/16"	4.8	38	118
CV600S09					
CV60BS09					
CV100S04	100,000 psi	1/4"	2.4	50Ø	129
CV100BS04					
CVNOS02	15,000 psi (NPT Type)	1/8"	3.2	25	81
CVNBS02		1/4"	3.2	25	81
CVNOS04					
CVNBS04		3/8"	3.2	25	81
CVNOS06					
CVNBS06					
CVNOS08	1/2"	5	35	106.2	
CVNBS08					
CVNOS12	10,000 psi (NPT Type)	3/4"	5	35	116.2
CVNBS12					
CVNOS16		1"	6	50.8	165.6
CVNBS16					

- As all sizes are for reference, they can be changed without any notification.
- We recommend you to use HiFLUX Fitting accessory Tube, Nipple for the most effective fitting.

High Pressure Ball Valve

Manual valve which is used to open or close the flow of fluids by the turning 1/4"(90°) or 1/2"(180°) with valve handle



Ball valve is a manual valve which is used to open or close the flow of fluids by the turning 1/4" (90°) or 1/2" (180°) with valve handle. HIFLUX Ball valve is using trunnion-type ball with seat and possible to use in the low pressure and high pressure environment without leakage. Peek which is good for abrasion resistance, rub resistance and chemical resistance is used for seat.

Features

- Trunnion Style BALL.
- Turn 1/4"(90°) or 1/2"(180°).
- Max Working Pressure : 20,000psi
- O-ring Material : Viton
- Standard Material : SUS316
- Advance of abrasion resistance, rub resistance and chemical resistance with PEEK for seat.

Exploded View & Dimensions

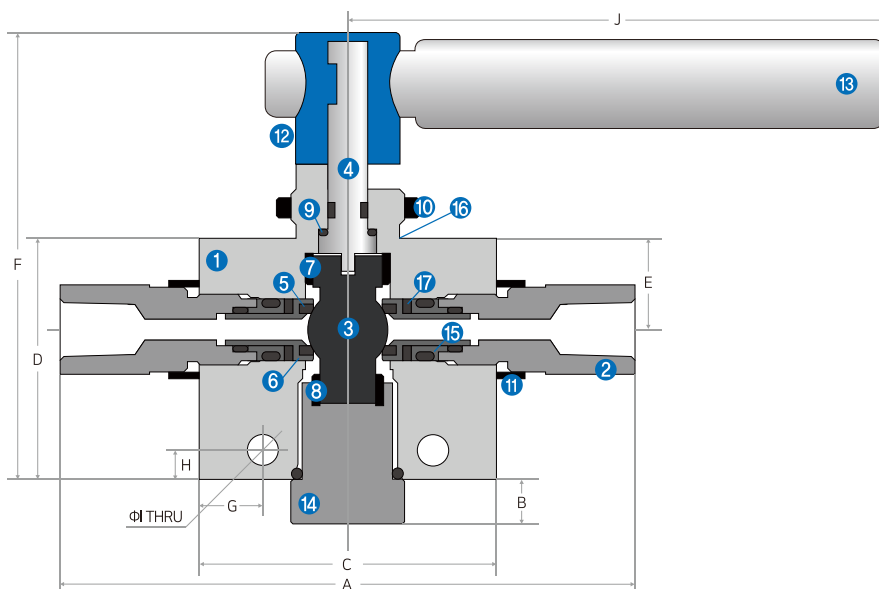

- 1 BODY
- 2 CONNECTOR
- 3 BALL
- 4 STEM
- 5 BALL SEAT
- 6 SEAT CARRIER
- 7 BEARING 1
- 8 BEARING 2
- 9 WASHER
- 10 PANEL LOCK NUT
- 11 LOCK NUT
- 12 HANDLE HOLDER
- 13 HANDLE
- 14 BOTTOM CONNECTOR
- 15 SEAT CARRIER GUIDE
- 16 PANEL
- 17 BELLEVILLE WASHERS

2way Type

90° 2-Way Trunnion

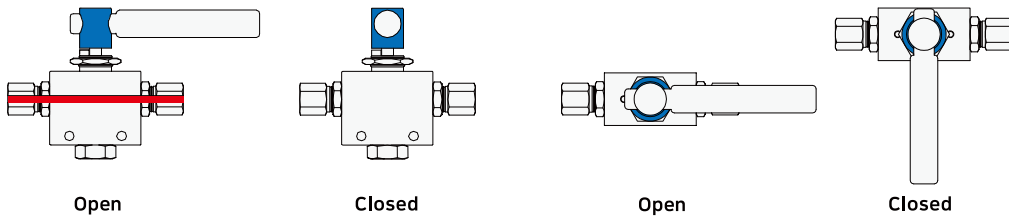

(Unit:mm)

Catalog No.	Pressure Rating (psi)	Port Type	Tube Size	Orifice Size	Minimum Orifice	Cv	Dimensions										Panel		
							A	B	C	D	E	F	G	H	I	J	Block Thickness	Diameter	Max Thickness
BV11S02-2-90	11,000	H1102	1/8"	4.8	1.4	0.09	118	10	66.5	54	20.5	100	14.2	6.5	7	120	38	25.4	6.4
BV11S04-2-90	11,500	H1104	1/4"		3.2	0.45	128												
BV11S06-2-90	7,500	H706	3/8"		4.8	1.45	128												
BV20S04-2-90	20,000	H2004	1/4"		2.8	0.31	128												
BV20S06-2-90	20,000	H2006	3/8"		4.8	1.45	128												
BV20S09-2-90	20,000	H2009	9/16"		4.8	1.45	138												
BV60S04-2-90	20,000	H6004	1/4"		2.4	0.2	128												
BV60S06-2-90	20,000	H6006	3/8"		3.2	0.45	128												
BV60S09-2-90	20,000	H6009	9/16"		4.8	1.45	138												
BVNS02-2-90	15,000	1/8" NPT	1/8"		4.8	1.45	128												
BVNS04-2-90	15,000	1/4" NPT	1/4"		4.8	1.45	128												
BVNS06-2-90	15,000	3/8" NPT	3/8"		4.8	1.45	128												
BVPS02-2-90	15,000	1/8" PT	1/8"		4.8	1.45	128												
BVPS04-2-90	15,000	1/4" PT	1/4"		4.8	1.45	128												
BVPS06-2-90	15,000	3/8" PT	3/8"		4.8	1.45	128												

As all sizes are for reference, they can be changed without any notification.

3way Type

180° 3-Way Switching

90° 3-Way Diverter

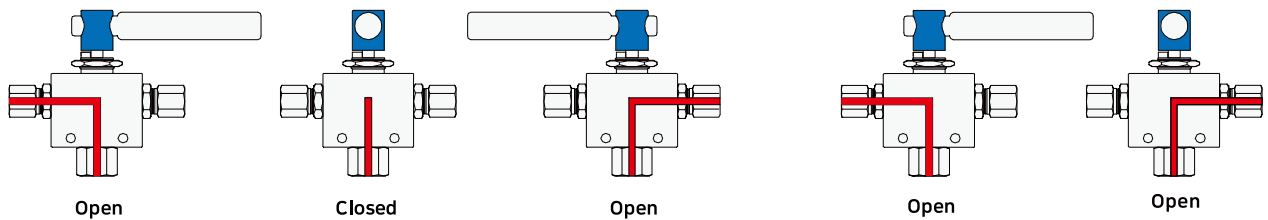

(Unit:mm)

Catalog No.	Pressure Rating (psi)	Port Type	Tube Size	Orifice Size	Minimum Orifice	Cv	Dimensions										Panel		
							A	B	C	D	E	F	G	H	I	J	Block Thickness	Diameter	Max Thickness
BV11S02-3-180	11,000	H1102	1/8"	4.8	1.4	0.04	118	13	66.5	54	20.5	100	14.2	6.5	7	120	38	25.4	6.4
BV11S04-3-180	11,500	H1104	1/4"		3.2	0.22	128	17											
BV11S06-3-180	7,500	H706	3/8"		4.8	0.71	128	21											
BV20S04-3-180	20,000	H2004	1/4"		2.8	0.15	128	17											
BV20S06-3-180	20,000	H2006	3/8"		4.8	0.71	128	21											
BV20S09-3-180	20,000	H2009	9/16"		4.8	0.71	138	25											
BV60S04-3-180	20,000	H6004	1/4"		2.4	0.1	128	17											
BV60S06-3-180	20,000	H6006	3/8"		3.2	0.22	128	21											
BV60S09-3-180	20,000	H6009	9/16"		4.8	0.71	138	25											
BVNS02-3-180	15,000	1/8" NPT	1/8"		4.8	0.71	128	13											
BVNS04-3-180	15,000	1/4" NPT	1/4"		4.8	0.71	128	21											
BVNS06-3-180	15,000	3/8" NPT	3/8"		4.8	0.71	128	21											
BVPS02-3-180	15,000	1/8" PT	1/8"		4.8	0.71	128	13											
BVPS04-3-180	15,000	1/4" PT	1/4"		4.8	0.71	128	21											
BVPS06-3-180	15,000	3/8" PT	3/8"		4.8	0.71	128	21											

As all sizes are for reference, they can be changed without any notification.

Air Operated Valve

Air automatic valve that automatically open and closed the valve using air pressure



Features

- 2 Patterns Body Types. (Normal Open, Normal Closed Type)
- Normal Open Type : When valve is open in normal, if air is supplied, it will be close automatically.
- Normal Closed Type : When valve is closed in normal, if air is supplied, it will be open automatically.
- The minimum working pressure of air is 5kgf/cm².
- The underbody of A.O.V where liquid or gas passes through also have 4 types as needle valve.
- The system can be controlled remotely.
- Driven by air, the explosion-proof valve is safer than electric type which may explode.
- A valve using stainless steel 316 cold material for excellent corrosion resistant.

Exploded View & Dimensions

- | | |
|-------------------------|---|
| ① Spring | ② Round plate |
| ③ Incoming air pressure | ④ The stem connected to the round plate |
| ⑤ Valve body | ⑥ Connections |

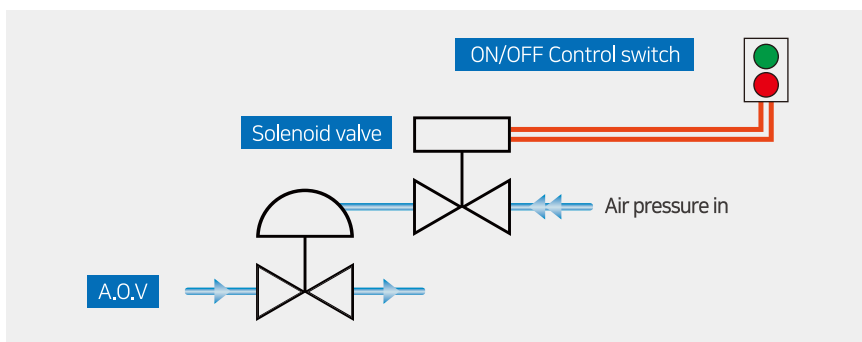
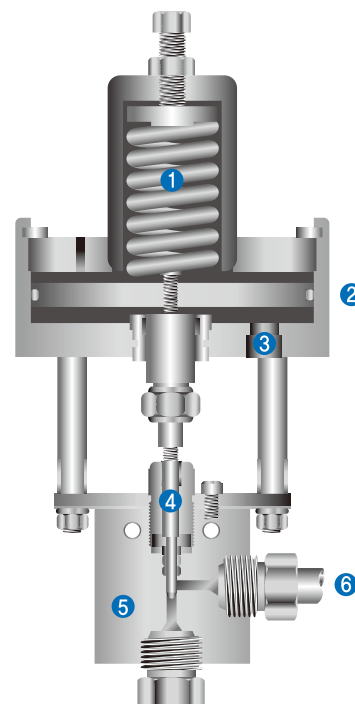

Normal - Open Type



1. In the Normal-open type, the stem connected with the round plate is in an upper position in normal times, so the valve is open.
2. If air pressure is applied from the lower side at this time, the round plate is moved upward by incoming air pressure.
3. The closed orifice is opened and the fluid (or gas) flows.
4. To close the valve again, you should block incoming air pressure and vent air within the product.
5. The round plate and the stem goes downward again with the restitution force of a spring located in the upper part, the valve closes and blocks the flow of the fluid.

Normal - Closed Type



1. In the Normal-closed type, the stem connected with the round plate goes downward in normal times and the valve is closed.
2. If air pressure is applied from the lower side at this time, the round plate is moved upward by incoming air pressure.
3. The closed orifice is opened and the fluid (or gas) flows.
4. To close the valve again, you should block incoming air pressure and vent air within the product.
5. The round plate and the stem go downward again with the restitution force of a spring located in the upper part, the valve closes and blocks the flow of the fluid.

The underbody of AOV where liquid or gas passes through also have 4 types as needle valve.

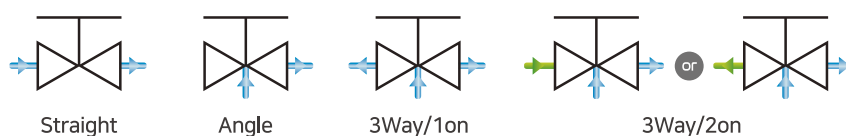

Pressure Rating	Tube Size	NORMAL-OPEN				NORMAL-CLOSED			
		Straight	Angle	3way/1on	3way/2on	Straight	Angle	3way/1on	3way/2on
11,000psi	1/8"	AOV110S02-S	AOV110S02-A	AOV110S02-O	AOV110S02-T	AOV11CS02-S	AOV11CS02-A	AOV11CS02-O	AOV11CS02-T
11,500psi	1/4"	AOV110S04-S	AOV110S04-A	AOV110S04-O	AOV110S04-T	AOV11CS04-S	AOV11CS04-A	AOV11CS04-O	AOV11CS04-T
7,500psi	3/8"	AOV110S06-S	AOV110S06-A	AOV110S06-O	AOV110S06-T	AOV11CS06-S	AOV11CS06-A	AOV11CS06-O	AOV11CS06-T
5,500psi	1/2"	AOV110S08-S	AOV110S08-A	AOV110S08-O	AOV110S08-T	AOV11CS08-S	AOV11CS08-A	AOV11CS08-O	AOV11CS08-T
20,000psi	1/4"	AOV200S04-S	AOV200S04-A	AOV200S04-O	AOV200S04-T	AOV20CS04-S	AOV20CS04-A	AOV20CS04-O	AOV20CS04-T
	3/8"	AOV200S06-S	AOV200S06-A	AOV200S06-O	AOV200S06-T	AOV20CS06-S	AOV20CS06-A	AOV20CS06-O	AOV20CS06-T
	9/16"	AOV200S09-S	AOV200S09-A	AOV200S09-O	AOV200S09-T	AOV20CS09-S	AOV20CS09-A	AOV20CS09-O	AOV20CS09-T
	3/4"	AOV200S12-S	AOV200S12-A	AOV200S12-O	AOV200S12-T	AOV20CS12-S	AOV20CS12-A	AOV20CS12-O	AOV20CS12-T
	1"	AOV200S16-S	AOV200S16-A	AOV200S16-O	AOV200S16-T	AOV20CS16-S	AOV20CS16-A	AOV20CS16-O	AOV20CS16-T
60,000psi	1/4"	AOV600S04-S	AOV600S04-A	AOV600S04-O	AOV600S04-T	AOV60CS04-S	AOV60CS04-A	AOV60CS04-O	AOV60CS04-T
	3/8"	AOV600S06-S	AOV600S06-A	AOV600S06-O	AOV600S06-T	AOV60CS06-S	AOV60CS06-A	AOV60CS06-O	AOV60CS06-T
	9/16"	AOV600S09-S	AOV600S09-A	AOV600S09-O	AOV600S09-T	AOV60CS09-S	AOV60CS09-A	AOV60CS09-O	AOV60CS09-T

Control Valve

Regulate flow of fluid automatically according to the signal from positioner



When electricity is transferred to the positioner of the control valve, the positioner controls the flow by changing the position of the stem, which regulates the flow by opening and closing the orifice. The hiflux control valve is designed with the properties of both gas and fluid as well as the operational pressure and temperature in mind for stability and safety in operation and resistance to corrosion.

Features

- Minimum required air pressure : 5kgf/cm²
- Non-spinning stem prevents galling.
- Package designed for maximum sealing.
- Metal to metal seating type to lengthen the life of the seat.
- Regulating stem for better flow control.
- Max Working Pressure : 3,000psi, 7,500psi
- Pipe Size : 15A, 25A
- Cold-formed stainless steel.

Exploded View & Dimensions

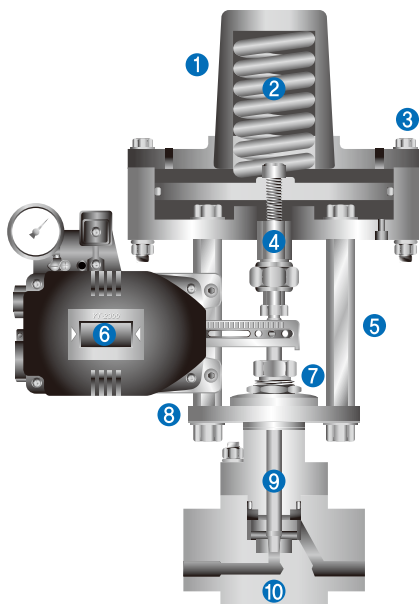

- 1 Spring housing
- 2 Spring
- 3 Nut
- 4 Connecting rod
- 5 Support bar
- 6 Positioner
- 7 Stem seal gland
- 8 Bracket
- 9 Stem
- 10 Valve body

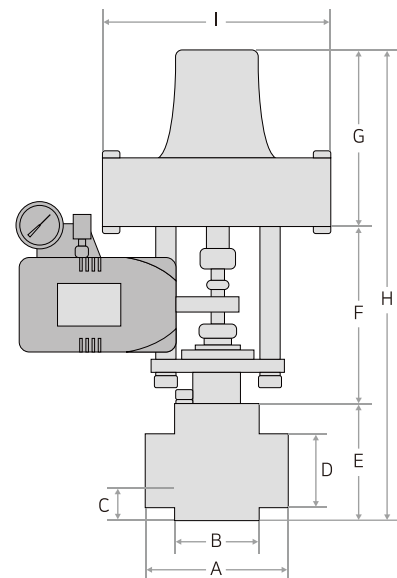

(Unit:mm)

Catalog No.	Pressure Rating	Pipe Size	Orifice Size	Cv	A	B	C	D	E	F	G	H	I
CON03CS15-S	3,000 psi	15A	0	9	136	80	30	75	110	166.6	171	448	219
CON03CS25-S	3,000 psi	25A	0	9	136	80	30	75	110	166.6	171	448	219
CON07CS15-S	7,500 psi	15A	0	9	136	80	30	75	110	166.6	171	448	219

As all sizes are for reference, they can be changed without any notification.

Wellhead Gauge Valve

Needle valves for sampling and calibration of measuring instruments



Features

- Tube Size : 1/4", 3/8", 9/16"
- Max allowed working pressure : 30,000 psig.
- Prevents galling due to the no-rotation stem.
- Packing designed for reliable sealing.
- Metal to Metal sealing type.
- One inlet port with 3 outlet port.
- Stainless steel 316 cold material for excellent corrosion resistant.
- Packing located below stem threads.

Wellhead gauge valve can be installed for sampling and calibration instruments, it is possible to take a sample from the line with installed bleed valve and possible to assemble and disassemble the instrument for calibration. The maximum working pressure is 30,000 psig with one inlet port and 3 outlet ports and bleed valve, gauge or other instruments can be assembled for special purpose. (Application - Sampling Lines, Calibration for Instruments)

Exploded View & Dimensions

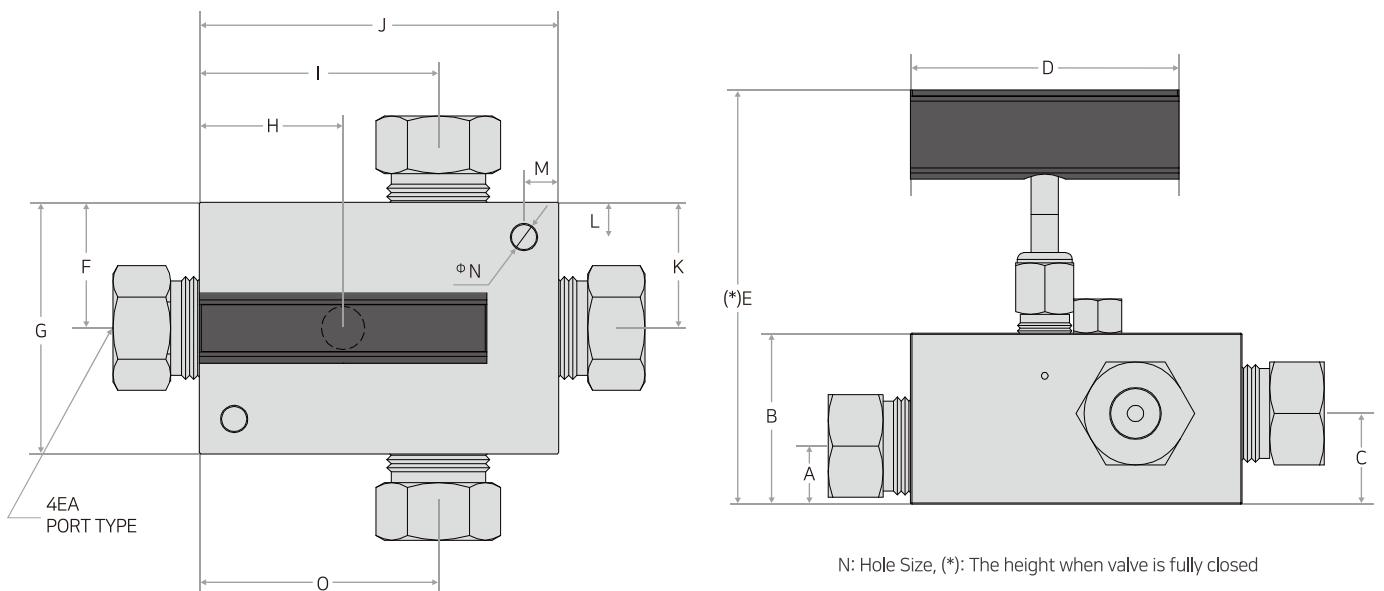

(Unit:mm)

Catalog No.	STEM	Port Type	Pressure Rating	Tube Size	Orifice Size	Dimensions														
						A	B	C	D	(*)E	F	G	H	I	J	K	L	M	N	O
GV20VS04	Vee	H2004	20,000 psi	1/4"	3.2	10	50	22.5	80	118.6	25	50	30	51.5	80	25	6.4	6.4	7	51.5
GV20VS06	Vee	H2006		3/8"	3.2															
GV30VS09	Vee	H6009	30,000 psi	9/16"	3.2	17	50	26.5	80	121	35	70	40	66.5	100	35	9.7	9.7	7	66.5

As all sizes are for reference, they can be changed without any notification.

Bleed Valve

Valves used for pressure venting on the line and for sampling small quantities



Bleed valve can be used before removing the instrument from the pressure line with the venting. It can be used for calibration instrument or sampling.

(Application - Pressure bleed, Sampling small amount)

Features

- One piece hex construction supply easy installation.
- Max allowed working pressure : 30,000 psig.
- Vent port tapped for safe plumbing.
- Easy operation with tee handle.
- Metal to Metal sealing.

Exploded View & Dimensions

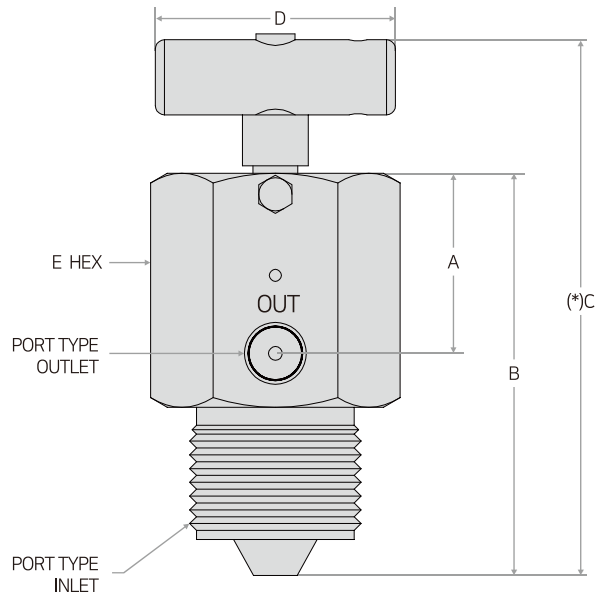
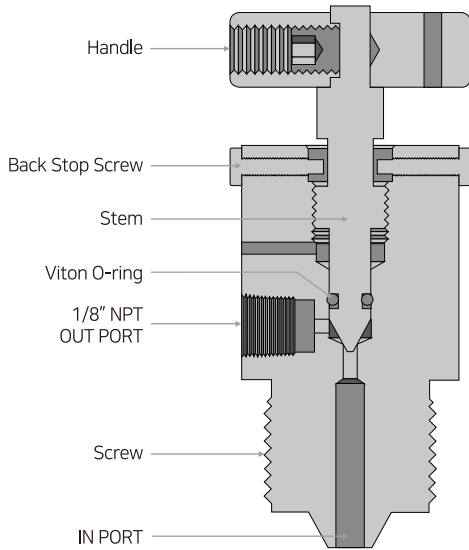

(*): The height when valve is fully closed

(Unit:mm)

Catalog No.	Port Type		Pressure Rating		Dimensions				
	INLET	OUTLET	INLET	OUTLET	A	B	(*)C	D	E(HEX)
BLV20VS04	H2004	1/8" NPT	20,000 psi	10,000 psi	30	56	78.24	40	46
BLV20VS06	H2006					60	82.24		
BLV20VS09	H2009					64	86.24		
BLV30VS04	H6004	1/8" NPT	30,000 psi	10,000 psi	30	54	76.24	40	36
BLV30VS06	H6006					62.5	84.74		
BLV30VS09	H6009					67	89.24		

As all sizes are for reference, they can be changed without any notification.

Double Block and Bleed Valve

Valve that is installed on line that uses gas or oil and maintains maintenance by blocking only Leak occurrence when leaking



Features

- Tube size : 1/4", 3/8"
- Prevents galling due to the no-rotation stem.
- Packing designed for reliable sealing.
- Metal to Metal sealing type.
- A valve using stainless steel 316 cold material for excellent corrosion resistant.
- Cone and thread connection to prevent gas or liquid leaking.

Double block and bleed valve is installed gas or oil line and it is expeditious to check the leakage.

If the leakage is occurred, shut-off the leakage line and help to maintenance easily. It also can be used to inject the chemical to the line or can be used for sampling process from the line.

(Application - Pressure monitoring, Pressure Test, chemical injection, Sampling, Drain line isolation)

Exploded View & Dimensions

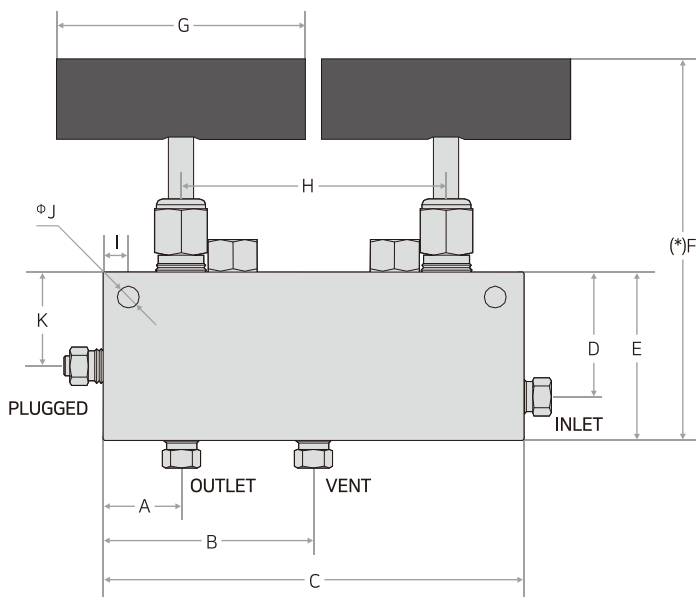

J: Hole Size, (*): The height when valve is fully closed

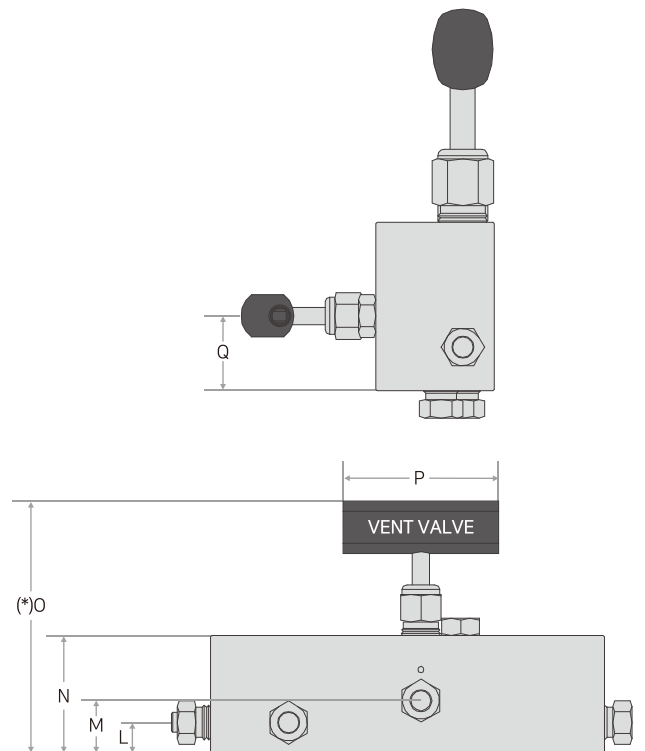

(Unit:mm)

Catalog No.	STEM	Port Type	Pressure Rating	Tube Size	Orifice Size	Dimensions															
						A	B	C	D	E	(*)F	G	H	I	J	K	L	M	N	O	P
DBBV20VS04	Vee	H2004	20,000 psi	1/4"	3.2	25	67.5	135	40	54	122.6	80	85	8	7	30	10	17	38	81.2	50
DBBV20VS06	Vee	H2006		3/8"	5.5																

As all sizes are for reference, they can be changed without any notification.

High Temperature Valve

Usable up to 500°C



The high temperature valves reduce the temperature for packing material by separating the packings materials from the hot area where the fluid flows.

Features

- Max Working Pressure : 20,000psi
- Prevents galling due to the no-rotation stem.
- Packing designed for reliable sealing.
- Metal to Metal sealing type.
- Excellent corrosion resistant.
- Packing zone is located out of Hot zone.
- Reduce the heating conduction with using radiating pipe.
- 4-Pattern Body Type.
(Straight, Angle, 3Way/1on pressure, 3Way/2on pressure)

Exploded View & Dimensions

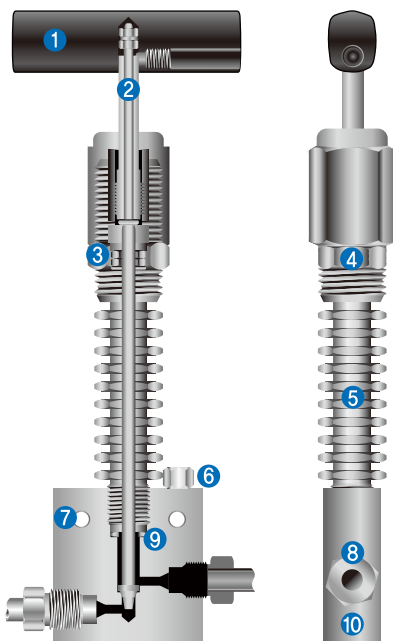

- 1 Handle
- 2 Stem
- 3 Packing
- 4 Nut
- 5 Radiating Pipe
- 6 Stem Locking
- 7 Valve Fixed Hole
- 8 Connections(Fitting)
- 9 SUS Seal
- 10 Valve Body

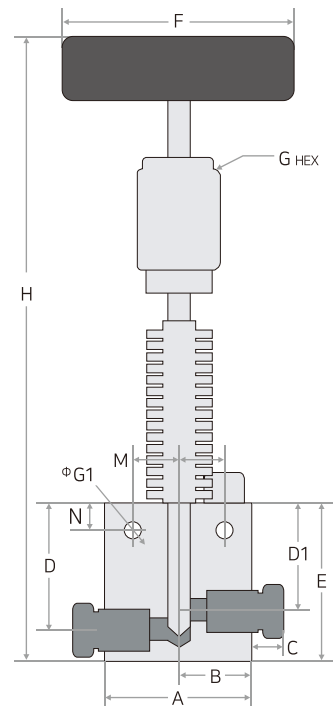

(Unit:mm)

Catalog No.	STEM	Port Type	Pressure Rating	Tube Size	Orifice Size	Dimensions											Block Thickness	
						A	B	C	D	D1	E	F	G	G 1	H	M		N
HV20S04-S	Vee	H2004	20,000 psi	1/4"	2.8	50	25	11	40	30	50	80	28	6	211	16.7	9.7	20
HV20S06-S	Vee	H2006		3/8"	5.2	50	25	13	40	30	50	80	28	6	211	16.7	9.7	20
HV20S09-S	Vee	H2009		9/16"	9.1	63	31.5	16	60	44	73	80	32	8	235	17.6	12.7	25

• G : The main top of the hole size • H : Height of the valve is fully closed
• G1 : Hole size of the main positive

As all sizes are for reference, they can be changed without any notification.

Relief Valve - Factory Set

Safety valve that protects the system by venting the pressure when over pressure occurs



It vents the pressure when the pressure is over than setting pressure and protects the pressure the system and equipment with venting. it hold the lower pressure than setting pressure after venting. Supply with set pressure (Customer requirement) with sealing tag.

Features

- Pressure Range : 3,000psi ~ 60,000psi
- Setting Pressure Tolerance : $\pm 8\%$
- Inlet Port : H6009 (Orifice size : ϕ 6.4)
- Outlet Port : 1/2" NPT
- Standard Material : Steel Use Stainless
- O-ring Material on Piston : Viton
- Max Operating Temperature : 170°C

Exploded View & Dimensions

- ① CAP
- ② LOCK NUT
- ③ SPRING CAP
- ④ HOUSING
- ⑤ BODY
- ⑥ SPINDLE
- ⑦ PLUG
- ⑧ SEAT
- ⑨ ADAPTER
- ⑩ SPRING
- ⑪ VITON O-RING

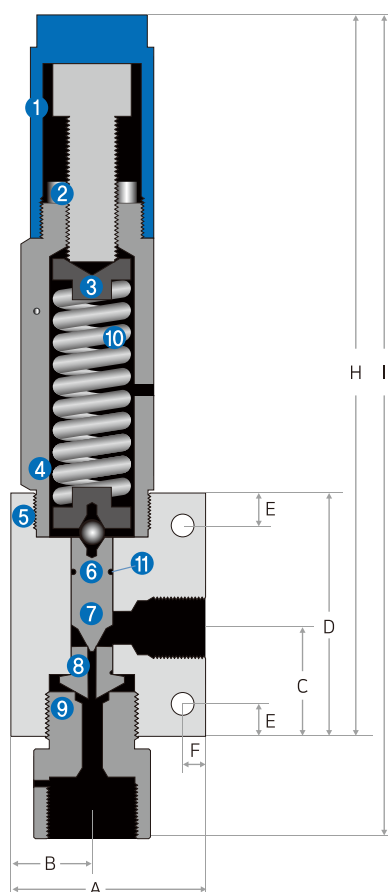

(Unit:mm)

Catalog No.	Port Type		Orifice Size	Pressure Range(PSI)		Dimensions								Block Thickness	
	Inlet	Outlet		Minimum	Maximum	A	B	C	D	E	F	G	H		I
RV10FS09	H6009	1/2" NPT	6.4	3,000	10,000	60	25	33.5	75	10	7	7	222.5	253.8	44
RV15FS09	H6009	1/2" NPT	4.8	10,000	15,000	60	25	33.5	75	10	7	7	222.5	253.8	44
RV30FS09	H6009	1/2" NPT	3.2	15,000	30,000	60	25	33.5	75	10	7	7	222.5	253.8	44
RV60FS09	H6009	1/2" NPT	2.4	30,000	60,000	60	25	33.5	75	10	7	7	222.5	253.8	44

As all sizes are for reference, they can be changed without any notification.

Relief Valve - Field Adjustable

Protect the system from overpressure by venting when the pressure exceeds a set value



Relief valve Field Adjustable protect the system from overpressure by venting when the pressure exceeds a set value, Easy to set pressure with using bolt on the top.

Features

- Pressure Range : 1,000psi ~ 10,000psi, 10,000psi ~ 20,000psi
- Setting Pressure Tolerance : $\pm 8\%$
- Max Working Temperature : $-20^{\circ}\text{C} \sim 65^{\circ}\text{C}$ (NYLON) / $-20^{\circ}\text{C} \sim 204^{\circ}\text{C}$ (PTFE)
- Inlet Port : 1/4" NPT, H2004
- Outlet Port : 1/4" NPT
- Orifice Size : $\phi 1.8$
- Possible to connect many other types with Adapter.
- Provide long life cycle with using spring and soft seat.

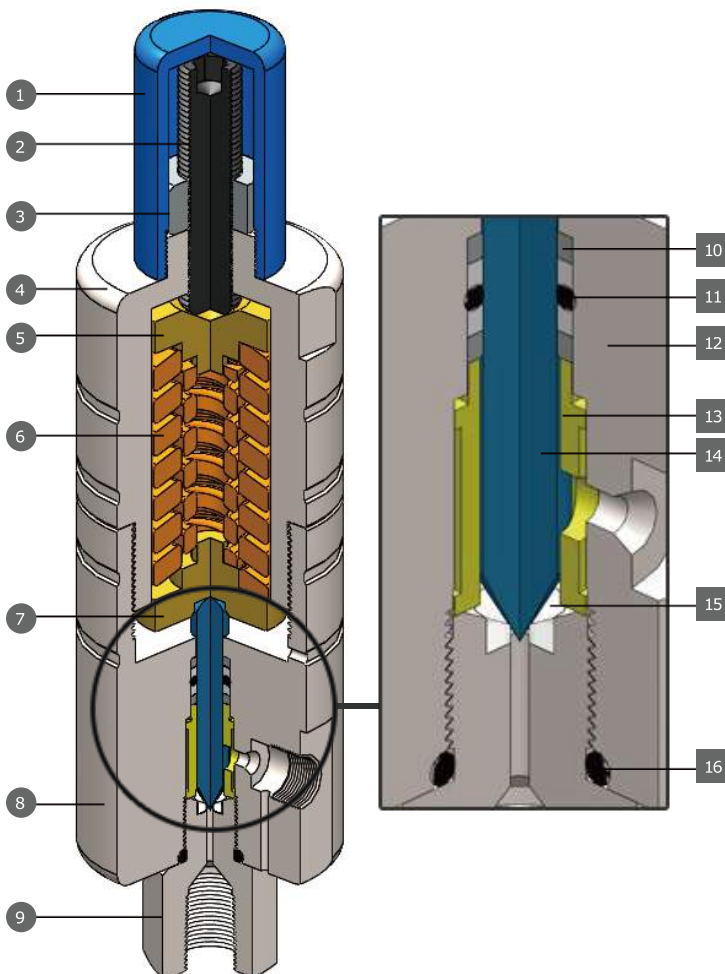
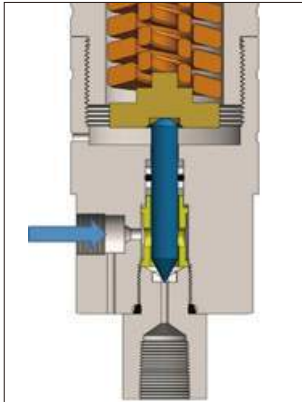

Table Of Material

No.	DESCRIPTION	MATERIAL
1	CAP	AL6061
2	Socket Set Screw	SCM435
3	NUT	SUS304
4	HOUSING 1	SUS304,AL6061
5	SPRING GUIDE 1	SUS304
6	SPRING	Carbon Steel
7	SPRING GUIDE 2	SUS304
8	HOUSING 2	SUS316
9	SEAT GLAND	SUS316
10	SUS SEAL	SUS316
11	O-RING	Viton
12	GLASS SEAL	GLASS TEFLON
13	STEM GUIDE	SUS316
14	STEM	SUS630
15	SEAT	NYLON, PTFE
16	O-RING	Viton

HOW & WHERE



Close

Force of applied to Spring >> Force of applied to Stem

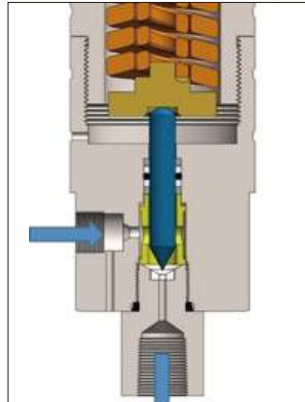

Open

Force of applied to Spring << Force of applied to Stem (It pushes the stem and opens valve)

HOW

Relief valve opens stem when the pressure exceeds a set pressure and closes when the pressure falls below.

WHERE

- To protect the equipment form the over pressure.
- In the system which control the overpressure by heat expansion.
- When the low drain rates is not the problem point in high pressure.
- When the system requires "bubble tight" sealing.

WHERE NOT

- Pressure ~ below 1000 psig.
- If the system requires to increase venting or drain rates when the pressure rises.
- If the back pressure occurs at the drain port.
- High corrosive fluids, liquid N2 or any other fluids that defect the valve.

Dimension Table

1 INLET Type

2 INLET Type

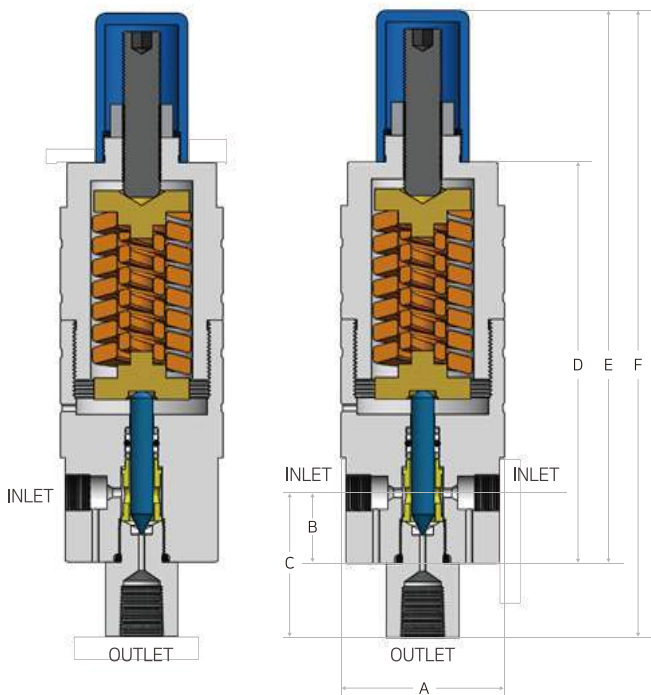

Technical Features

Feature	RV10FAS	RV20FAS
Pressure Range (PSIG)	1,000 ~ 10,000	10,000 ~ 20,000
Inlet Port	1/4" NPT	H2004
Outlet Port	1/4" NPT	
Orifice Size	1.8mm	
CV	0,12	
Packing Material	Nylon or PTFE	
O-ring Material	Viton	
Max Working Temperature	-20°C ~65°C (NYLON) / -20°C~204°C	
hexagon wrench tool size	5mm Use a ranch with six angles	6mm Use a ranch with six angles
Adjust dimension tolerance ±%	±8%	
Useable area	Water, Gas	

Set Pressure

Catalog No.	SET PRESSURE (psi)	Spring Compression Length(mm)
1,000 ~ 10,000psi RV10FAS04	2,500	2.58
	5,500	5.15
	7,500	7.73
	10,000	10.31
10,000 ~ 20,000psi RV20FAS04	12,500	6.96
	15,000	8.35
	17,500	9.74
	20,000	11.13

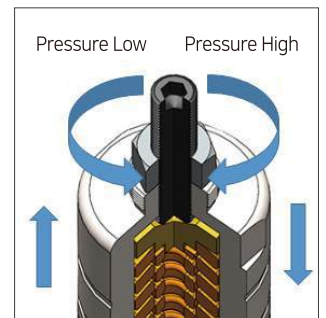

(Unit:mm)

Catalog No.	Port Type			Orifice Size	Pressure Range(PSI)		Dimensions						
	1 Inlet	2 Inlet	Outlet		Minimum	Maximum	A	B	C	D	E	F	G
RV10FAS04-1	1/4" NPT		1/4" NPT	1.8	1,000	10,000	38	21	43.1	112.5	158	180.1	28
RV10FAS04-2		1/4" NPT											
RV20FAS04-1	H2004		1/4" NPT	1.8	10,000	20,000	49.5	21	43.1	120	165.5	187.6	28
RV20FAS04-2		H2004											

As all sizes are for reference, they can be changed without any notification.

Relief Valve - Proportional Type

A valve that gradually opens as the system's internal pressure increases



Proportional type is a progressively opened as the system pressure increase. It is useful in the system which the pressure increase rapidly or in the high flow system due to vent flow is increased as much as system pressure is increased.

Features

- Pressure Range : 1,000psi ~ 15,000psi, 1,000psi ~ 20,000psi
- Setting Pressure Tolerance : $\pm 8\%$
- Inlet Port : 1/2"NPT, H2009 (9/16")
- Outlet Port : 1/2" NPT
- Orifice Size : ϕ 6.3
- Standard Material : SUS
- O-ring Material on Piston : Viton
- Max Operating Temperature : 160°C
- Possible to connect many other types with Adapter.
- Provide long life cycle with using spring and soft seat.
- Supply with set pressure (Customer requirement) with sealing tag.

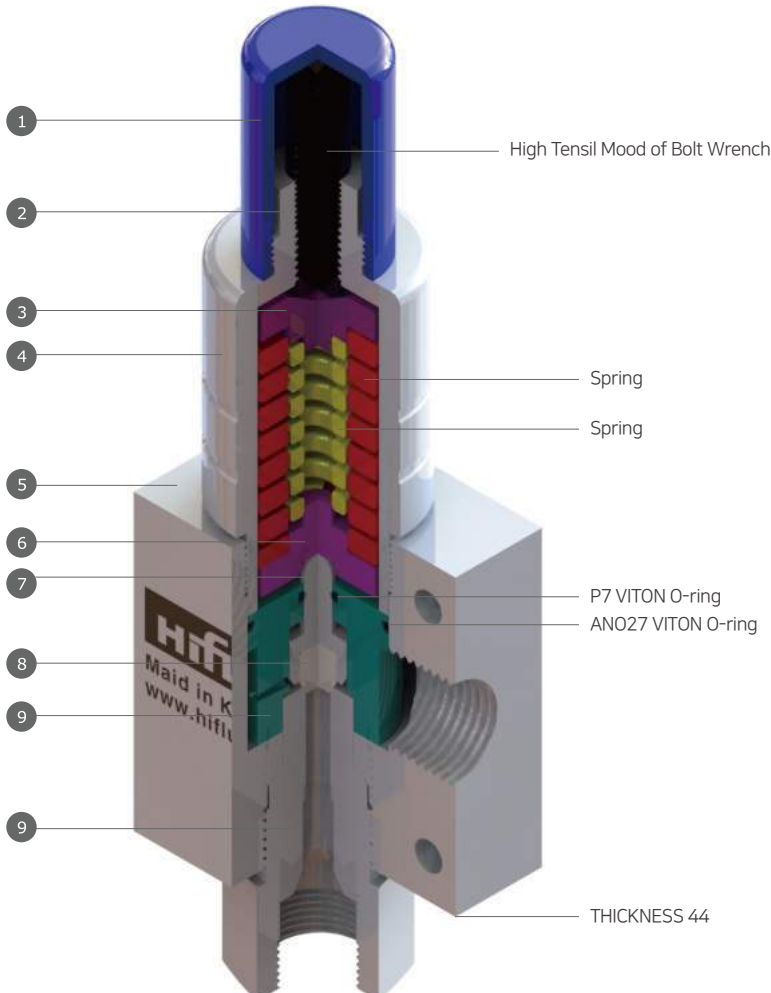

Table Of Material

No.	DESCRIPTION	MATERIAL
1	CAP	AL6061
2	SUS NUT	SUS304
3	SPRING GUIDE 1	SUS304
4	HOUSING	SUS304
5	BODY	SUS316CW
6	SPRING GUIDE 2	SUS304
7	STEM	SUS630
8	SEAT	PEEK, PTFE
9	STEM GUIDE	SUS316CW
10	BOTTOM CONNECTOR	SUS316CW

Technical Features

Feature	RV15PPS08N	RV20PPS09
Pressure Range (PSIG)	1,000 ~ 15,000	1,000 ~ 20,000
Inlet Port	1/2" NPT	H2009 (9/16")
Outlet Port	1/2" NPT	
Orifice Size	φ 6.3	
Packing Material	PEEK	
O-ring Material	Viton	
Max Working Temperature	-20°C ~ 160°C	
hexagon wrench tool size	6mm Use a ranch with six angles	
Adjust dimension tolerance ±%	±8%	
Useable area	Water, Gas	

How & Where

WHERE

- To protect the equipment form the over pressure.
- In the system which control the overpressure by heat expansion.
- When the low drain rates is not the problem point in high pressure.
- When the system requires "bubble tight" sealing.

WHERE NOT

- Pressure ~ below 1,000psi.
- If the system requires to increase venting or drain rates when the pressure rises.
- If the back pressure occurs at the drain port.
- High corrosive fluids, liquid N2 or any other fluids that defect the valves.

Specification

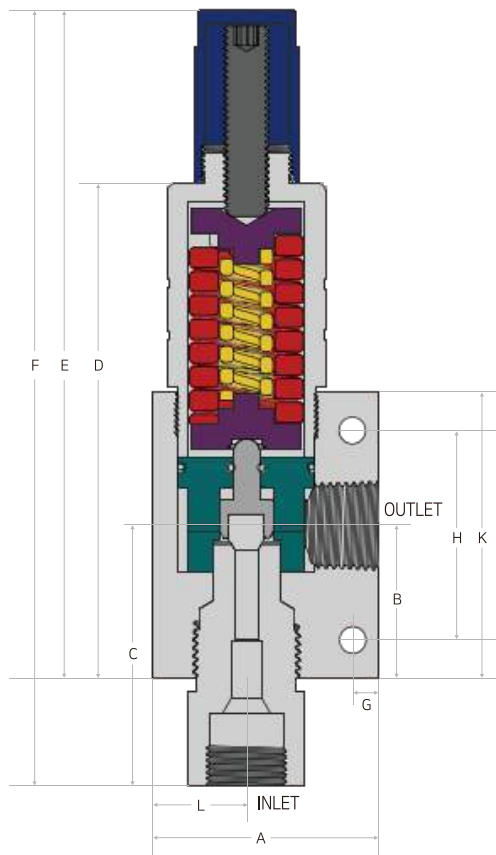

Set Pressure

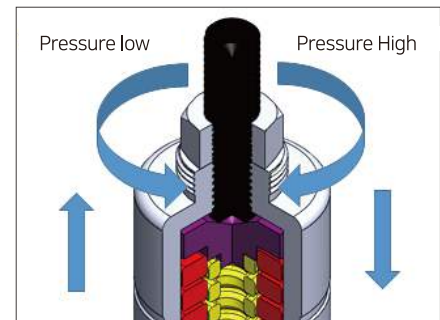

- The pressure of inlet port effects set pressure.
- Turn right to increase set pressure.
- Turn left to decrease set pressure.
- a tolerance value : ± 8%.

(Unit:mm)

Catalog No.	Port Type		Orifice Size	Pressure Range(PSI)		Dimensions											
	Inlet	Outlet		Minimum	Maximum	A	B	C	D	E	F	G	H	I	J	K	I
RV15PPS08N	1/2" NPT	1/2" NPT	6.3	1,000	15,000	60	40	68.2	130	175.5	203.7	7	55	28	7	75	25
RV20PPS09	H2009 (9/16")	1/2" NPT	6.3	1,000	20,000	60	40	68.2	130	175.5	203.7	7	55	28	7	75	25

As all sizes are for reference, they can be changed without any notification.

Safety Head & Rupture Disc

Safety valve to protect and prevent overpressure of equipment and piping



Safety head is assembly housing for pressure burst disc. It is used to prevent damage and explosion and to protect the equipment with releasing the pressure quickly, in case of over pressure. It requires the burst disc which is called Rupture Disc that burst on overpressure condition.

Features

- To protect the equipment damage.
- No leaking before the rupture disc burst case.
- Stainless steel 316 material. (Except 1,000psig : Nickel)
- 3/8" NPT Outlet design to connect vent lines.
- Include fitting accessories for suitable pressure and sizes for tubing.
- Manufactured with a tolerance of plus 6% and minus 3% of specified burst pressure.
- Rupture disc is not included in this item required to choose proper rupture disc separately. (Rupture Disc Spec.)

Pressure Release Time

- ① In case of pressure is increase rapidly.
- ② Not allow for any leaking.
- ③ When system requires to release in short time.

Consideration of selection

- ① Set pressure, Temp and medium.
- ② Operation condition (Static/Back Pressure, pulsating, Etc.,).
- ③ Recommend regularly under the corrosion, metal fatigue, repeating environment.

Catalog No.	Pressure Rating	Inlet Port Size	Outlet Port Size	Rupture Disc Spec.			
				Standard Burst Pressure (in psi at 72°F)			
SH11S02	11,000 psi	1/8"	3/8" NPT	1,000	1,500	2,000	2,500
SH11S04	11,500 psi	1/4"		3,000	3,500	4,000	4,500
SH11S06	7,500 psi	3/8"		5,000	5,500	6,000	6,500
SH11S08	5,500 psi	1/2"		7,000	7,500	8,000	8,500
SH20S04	20,000 psi	1/4"		9,000	9,500	10,000	10,500
SH20S06		3/8"		11,000	11,500		
SH20S09		9/16"					
SH20S12		3/4"		12,500	15,000	17,500	18,000
SH20S16		1"		20,000			
SH60S04	60,000 psi	1/4"		22,500	25,000	27,000	30,000
SH60S06		3/8"		35,000	37,500	40,000	45,000
SH60S09		9/16"		50,000	55,000	60,000	65,000

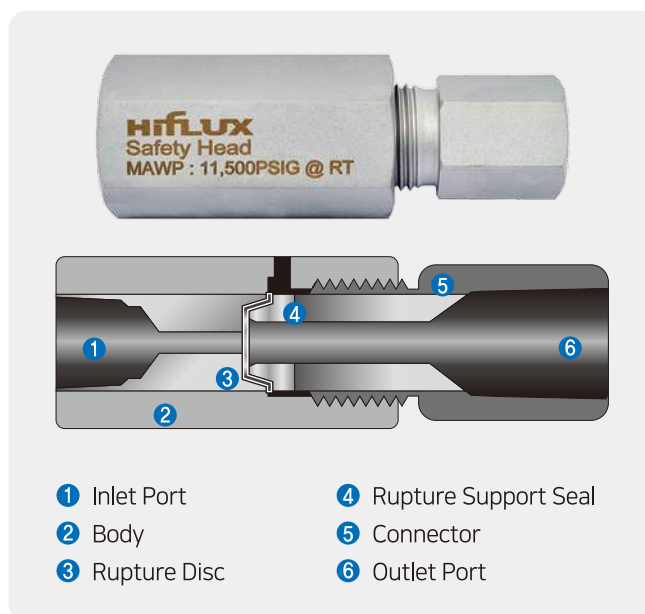

- ① Inlet Port
- ② Body
- ③ Rupture Disc
- ④ Rupture Support Seal
- ⑤ Connector
- ⑥ Outlet Port

High Pressure Manifold Block

Connection or divide the tubing lines which has same pressure or various pressure tubing lines



HiFLUX Manifold block - Connection or divide the tubing lines which has same pressure or various pressure tubing lines. Possible to supply for customer requirement sizes or specification.

Features

- Stainless steel 316 material used.
- The operation temperature ranges from -423°F (-252°C) to 1200°F (649°C).
- Possible to supply for customer requirement sizes or specification.
- possible to supply which has difference port sizes and other types.

4-way Type

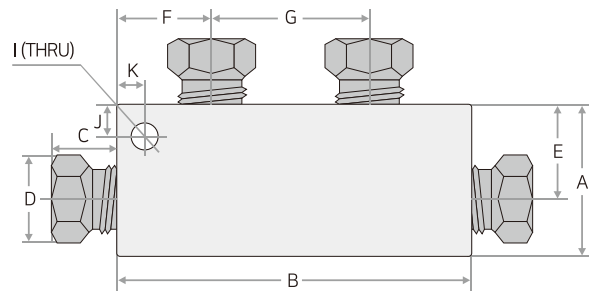

(Unit:mm)

Catalog No.	Pressure Rating	Port Type	Tube Size	Orifice Size	Dimensions										Block Thickness
					A	B	C	D(HEX)	E	F	G	I	J	K	
MF11S02-4	11,000 psi	H1102	1/8"	1.4	25	68	12.1	12	19	19	30	6	7	7	15.5
MF11S04-4	11,500 psi	H1104	1/4"	3.5	35	85	11.8	16	25	25	35	6	7	7	20
MF11S06-4	7,500 psi	H706	3/8"	5.5	35	85	14	20	25	25	35	6	7	7	20
MF11S08-4	5,500 psi	H508	1/2"	8.5	45	128	16.3	25	31.5	31.5	65	6	7	7	25
MF20S04-4	20,000 psi	H2004	1/4"	2.8	25	74	10.8	12	17.5	22	30	6	6	7	16
MF20S06-4		H2006	3/8"	5.2	35	85	13.1	16	25	25	35	6	7	7	20
MF20S09-4		H2009	9/16"	7.9	45	118	16	22	31.5	31.5	55	6	7	7	25
MF20S12-4		H2012	3/4"	11.1	57	151	18.6	30	38	38	75	10	10	10	35
MF20S16-4		H2016	1"	17.5	76	195	21.7	36	52.5	52.5	90	10	10	10	45
MF60S04-4	60,000 psi	H6004	1/4"	2.4	35	80	14.5	16	22.5	22.5	35	6	7	7	25
MF60S06-4		H6006	3/8"	3.2	38	108	17	20	25	31.5	45	6	7	7	25
MF60S09-4		H6009	9/16"	4.8	47.5	171	23.5	30	28.5	48	75	6	7	7	38

As all sizes are for reference, they can be changed without any notification.

5-way Type

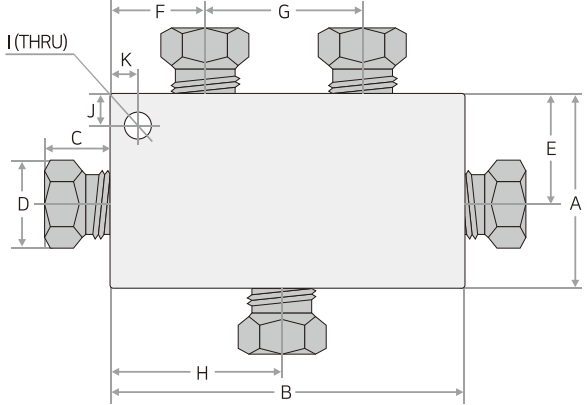

(Unit:mm)

Catalog No.	Pressure Rating	Port Type	Tube Size	Orifice Size	Dimensions											Block Thickness
					A	B	C	D(HEX)	E	F	G	H	I	J	K	
MF11S02-5	11,000 psi	H1102	1/8"	1.4	38	68	12.1	12	19	19	30	34	6	7	7	15.5
MF11S04-5	11,500 psi	H1104	1/4"	3.5	50	85	11.8	16	25	25	35	42.5	6	7	7	20
MF11S06-5	7,500 psi	H706	3/8"	5.5	50	85	14	20	25	25	35	42.5	6	7	7	20
MF11S08-5	5,500 psi	H508	1/2"	8.5	63	128	16.3	25	31.5	31.5	65	64	6	7	7	25
MF20S04-5	20,000 psi	H2004	1/4"	2.8	35	74	10.8	12	17.5	22	30	37	6	6	7	16
MF20S06-5		H2006	3/8"	5.2	50	85	13.1	16	25	25	35	42.5	6	7	7	20
MF20S09-5		H2009	9/16"	7.9	63	118	16	22	31.5	31.5	55	59	6	7	7	25
MF20S12-5		H2012	3/4"	11.1	76	151	18.6	30	38	38	75	75.5	10	10	10	35
MF20S16-5		H2016	1"	17.5	105	195	21.7	36	52.5	52.5	90	97.5	10	10	10	45
MF60S04-5	60,000 psi	H6004	1/4"	2.4	50	80	14.5	16	25	22.5	35	40	6	7	7	25
MF60S06-5		H6006	3/8"	3.2	50	108	17	20	25	31.5	45	54	6	7	7	25
MF60S09-5		H6009	9/16"	4.8	67	171	23.5	30	33.5	48	75	85.5	6	7	7	38

As all sizes are for reference, they can be changed without any notification.

6-way Type

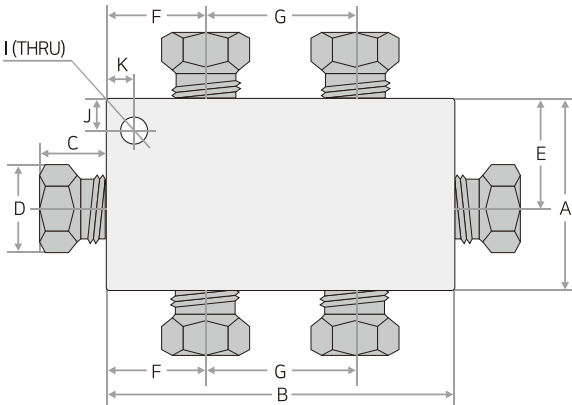

(Unit:mm)

Catalog No.	Pressure Rating	Port Type	Tube Size	Orifice Size	Dimensions											Block Thickness
					A	B	C	D(HEX)	E	F	G	I	J	K		
MF11S02-6	11,000 psi	H1102	1/8"	1.4	25	68	12.1	12	19	19	30	6	7	7	15.5	
MF11S04-6	11,500 psi	H1104	1/4"	3.5	35	85	11.8	16	25	25	35	6	7	7	20	
MF11S06-6	7,500 psi	H706	3/8"	5.5	35	85	14	20	25	25	35	6	7	7	20	
MF11S08-6	5,500 psi	H508	1/2"	8.5	45	128	16.3	25	31.5	31.5	65	6	7	7	25	
MF20S04-6	20,000 psi	H2004	1/4"	2.8	25	74	10.8	12	17.5	22	30	6	6	7	16	
MF20S06-6		H2006	3/8"	5.2	35	85	13.1	16	25	25	35	6	7	7	20	
MF20S09-6		H2009	9/16"	7.9	45	118	16	22	31.5	31.5	55	6	7	7	25	
MF20S12-6		H2012	3/4"	11.1	57	151	18.6	30	38	38	75	10	10	10	35	
MF20S16-6		H2016	1"	17.5	76	195	21.7	36	52.5	52.5	90	10	10	10	45	
MF60S04-6	60,000 psi	H6004	1/4"	2.4	35	80	14.5	16	22.5	22.5	35	6	7	7	25	
MF60S06-6		H6006	3/8"	3.2	38	108	17	20	25	31.5	45	6	7	7	25	
MF60S09-6		H6009	9/16"	4.8	47.5	171	23.5	30	28.5	48	75	6	7	7	38	

As all sizes are for reference, they can be changed without any notification.

Oil Based Thread Lubricant - BLUE LUBE

Special grease for long-term lubrication mixed with oil-based PTFE

Blue Lube is special lubricant with oil and PTFE. The solid lubricant contained in Blue Lube contribute to particularly low friction values and a high wear protection when screws & bolts are released and fastened. They should be tightened and released without much effort and definitely without damage to the screws, nuts or mating threads. Blue Lube can keep lubrication performance under the humidity and water conditions. It is resistant to oxidation and corrosion.

(Application : Use on stainless steel, steel, titanium, aluminum, and nickel-based alloys.)



Features

- Special grease for lifetime lubrication.
- Resists Galling.
- Resists water washout based on oil (Excellent resistance to water and media).
- Keep low torque when a screw is assembled.
- Good anti-wear property.
- Resistant to Oxidation and Corrosion.
- Service Temperature : -35 to 204°C
- Contains PTFE.



Possible to replace Blue Goop.



Warning - It is difficult to apply halogen, freon, nitrogen dioxide, strong acid and strong base.

High Pressure Tube

Using stainless steel 316 cold material for excellent corrosion resistant



Features

- Tube is sold in a 6000mm (6M) unit.
- Using stainless steel 316 cold material for excellent corrosion resistant.
- The operation temperature ranges from -423°F (-252°C) to 1200°F (649°C).
- If you want a water pressure test conducted, we can conduct the test based on a rule under pressure to be used.
- Suitable for chemical, oil refining, research, oil and gas companies, this product is used for various pressures.
- Our products generally are produced with Stainless steel materials, but they can be manufactured with other materials on demand so that various and gases can be used.

(Unit:mm)

Catalog No.	Pressure Rating	Port Type	Tube Size	Dimensions		Thickness	Flow Area(mm)	Working pressure psi (bar)				
				Outside Diameter	Inside Diameter			-17.8~37.8°C 0~100°F	93°C 200°F	204°C 400°F	316°C 600°F	343°C 650°F
T11S02	11,000 psi	H1102	1/8"	3.18	1.57	0.81	1.94	803.23	803.23	775.65	730.83	679.12
T11S04	11,500 psi	H1104	1/4"	6.35	3.18	1.57	7.74	803.23	761.86	775.65	730.83	679.12
T11S06	7,500 psi	H706	3/8"	9.53	6.35	1.57	31.61	517.10	517.10	496.41	468.84	434.36
T11S08	5,500 psi	H508	1/2"	12.7	9.53	1.57	70.97	379.21	379.21	361.97	341.29	317.15
								-198~-37.8°C -325~-100°F	93°C 200°F	204°C 400°F	316°C 600°F	427°C 800°F
T20S04	20,000 psi	H2004	1/4"	6.35	2.77	1.78	5.81	1378.93	1378.93	1327.22	1244.48	1158.30
T20S06		H2006	3/8"	9.53	5.16	2.18	20.65	1378.93	1378.93	1327.22	1244.48	1158.30
T20S09		H2009	9/16"	14.29	7.92	3.18	49.03	1378.93	1378.93	1327.22	1244.48	1158.30
T20S12		H2012	3/4"	19.05	11.13	3.96	97.42	1378.93	1378.93	1327.22	1244.48	1158.30
T20S16		H2016	1"	25.4	14.27	5.56	160.0	1378.93	1378.93	1327.22	1244.48	1158.30
T30S02	30,000 psi	H3002	1/8"	3.18	1.02	1.08						
T30S16		H3016	1"	25.4	11.1	7.15						
T60S04	60,000 psi	H6004	1/4"	6.35	2.11	2.11	3.23	4136.79	4136.79	3981.66	3740.35	3495.59
T60S06		H6006	3/8"	9.53	3.18	3.18	7.74	4136.79	4136.79	3981.66	3740.35	3495.59
T60S09		H6009	9/16"	14.29	4.78	4.75	18.06	4136.79	4136.79	3981.66	3740.35	3495.59
T100S04	100,000 psi	H10004	1/4"	6.35	1.59	2.38	3.23	6894.64	6864.64	6633.24	6230.55	5820.46
T150S06	150,000 psi	H15006	3/8"	9.53	1.59	3.97	7.74	10341.97	10341.97	9955.87	9400.85	8738.97

As all sizes are for reference, they can be changed without any notification.

High Pressure Nipple

For easy system setup, Cone and thread nipple



Features

- For easy system setup, cone and thread nipple of assorted tube size.
- Using stainless steel 316 cold material for excellent corrosion resistant.
- The operation temperature ranges from -423°F (-252°C) to 1200°F (649°C).
- Can be ordered one side and both sides types & Please let us know the length you need.
- Our products generally are produced with Stainless steel materials, but they can be manufactured with other materials on demand so that various and gases can be used.

(Unit:mm)

Catalog No.	Pressure Rating	Port Type	Tube Size	Dimensions		Thickness	Minimum Length	Flow Area(mm ²)	Working Pressure psi (bar)				
				Outside Diameter	Inside Diameter				-198~37.8°C -325~100°F	93°C 200°F	204°C 400°F	316°C 600°F	427°C 800°F
N20S04	20,000 psi	H2004	1/4"	6.35	2.77	1.78	70	5.81	1378.93	1378.93	1327.22	1244.48	1158.30
N20S06		H2006	3/8"	9.53	5.16	2.18	88	20.65	1378.93	1378.93	1327.22	1244.48	1158.30
N20S09		H2009	9/16"	14.29	7.92	3.18	110	49.03	1378.93	1378.93	1327.22	1244.48	1158.30
N20S12		H2012	3/4"	19.05	11.13	3.96	118	97.42	1378.93	1378.93	1327.22	1244.48	1158.30
N20S16		H2016	1"	25.4	14.27	5.56	168	160.0	1378.93	1378.93	1327.22	1244.48	1158.30
N30S02	30,000 psi	H3002	1/8"	3.18	1.02	1.08	43						
N30S16		H3016	1"	25.4	11.1	7.15	168						
N60S04	60,000 psi	H6004	1/4"	6.35	2.11	2.11	74	3.23	4136.79	4136.79	3981.66	3740.35	3495.59
N60S06		H6006	3/8"	9.53	3.18	3.18	104	7.74	4136.79	4136.79	3981.66	3740.35	3495.59
N60S09		H6009	9/16"	14.29	4.78	4.75	135	18.06	4136.79	4136.79	3981.66	3740.35	3495.59
N100S04	100,000 psi	H10004	1/4"	6.35	2.11	2.11	103	3.23	6894.64	6864.64	6633.24	6230.55	5820.46
N150S06	150,000 psi	H15006	3/8"	9.53	1.59	3.97	135	7.74	10341.97	10341.97	9955.87	9400.85	8738.97

As all sizes are for reference, they can be changed without any notification.



One Side Type



Both Side Type

Tooling Set

Tools for Cone and Thread work

Threading Tool



The Threading tool is designed for preparing a thread which is left hand type for the 20,000psig, 60,000psig and ultra high pressure connections. The threaded die and guide busings are interchangeable for all. (except 1/8" sizes)

Reseating Tool



The reseating tool is designed for repairing old or damaged tubing connection seats for valves and fittings. This does not require to have coning and threading tools.

Coning Tool



The Coning tool is designed for preparing to cone on the tubing ends for the 20,000psig, 60,000psig and ultra high pressure connections. The cone degrees are approximately 57 to 59°. The cutter and collets are interchangeable each other. (except 9/16" sizes)

Spare Collet & Cutter



Possible to do tubing ends for ultra high pressure & High pressure. Design to degree 57~59°.

Exploded View & Dimensions

- 1 Handle Set
- 2 Cap
- 3 Bearing
- 4 Cutter
- 5 Body
- 6 Tubing
- 7 Collet
- 8 Collet Nut
- 9 Guide Bushing
- 10 Housing
- 11 Die

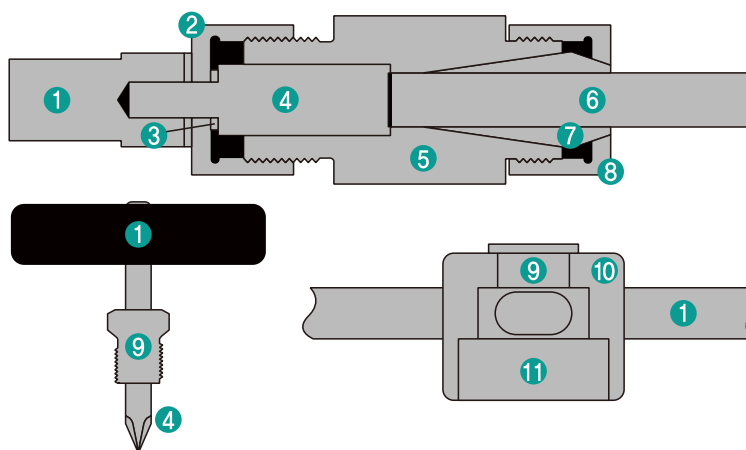

Pressure Rating	Tube Size	Catalog No.						
		Coning Tool			Threading Tool			Reseating Tool
		Set	Spare Cutter	Spare Collet	Set	Die	Guide Bushing	
20,000 psi	1/4"	CT-LF4	CT-LF4L	CT-LF4P	CT-MLF4	1/4" - 28LH	CT-MLF4P	RT-LF4
	3/8"	CT-LF6	CT-LF6L	CT-LF6P	CT-MLF6	3/8" - 24LH	CT-MLF6P	RT-LF6
	9/16"	CT-LF9	CT-LF9L	CT-LF9P	CT-MLF9	9/16" - 18LH	CT-MLF9P	RT-LF9
60,000 psi	1/4"	CT-HF4	CT-HF4L	CT-HF4P	CT-MHF4	1/4" - 28LH	CT-MHF4P	RT-HF4
	3/8"	CT-HF6	CT-HF6L	CT-HF6P	CT-MHF6	3/8" - 24LH	CT-MHF6P	RT-HF6
	9/16"	CT-HF9	CT-HF9L	CT-HF9P	CT-MHF9	9/16" - 18LH	CT-MHF9P	RT-HF9

Tube Support

Supports the tube or fixes the piping installed in the equipment where vibration occurs to reduce vibration of pipe due to vibration

■ 1 Line - 1/4 · 3/8 inch

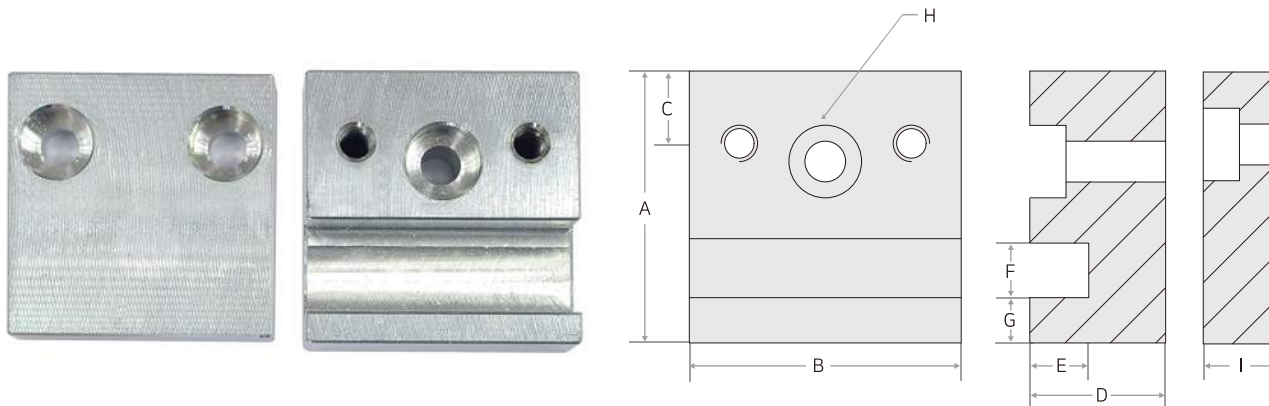

(Unit:mm)

Catalog No.	Tube Size	Dimensions									
		A	B	C	D	E	F	G	H	I	
TS04L1	1/4"	30	30	10	15	6	6.5	5	M4 C'B	8	
TS06L1	3/8"	30	30	10	15	9	9.7	4	M4 C'B	8	

As all sizes are for reference, they can be changed without any notification.

■ 1 Line - 1/2 · 9/16 inch

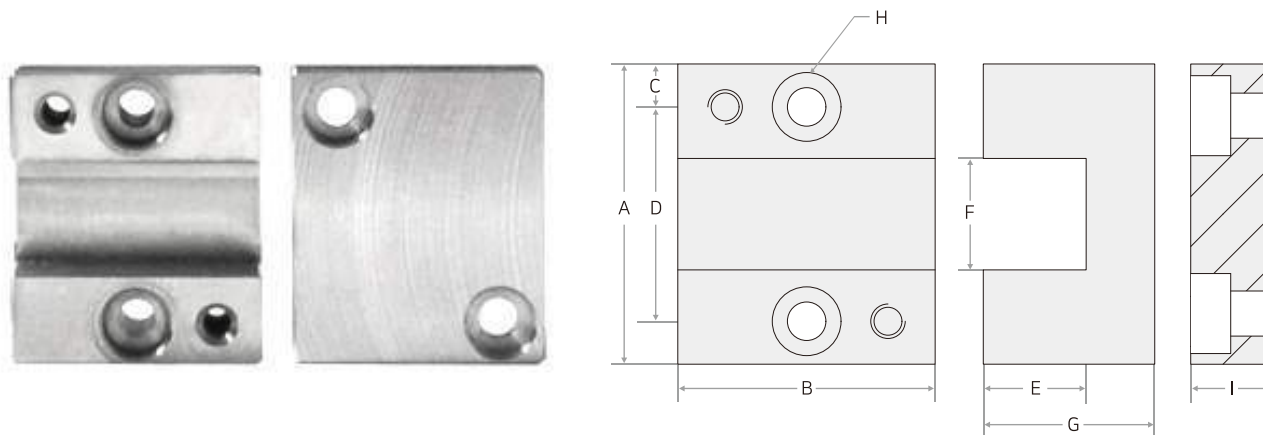

(Unit:mm)

Catalog No.	Tube Size	Dimensions									
		A	B	C	D	E	F	G	H	I	
TS08L1	1/2"	35	30	5	25	12	13	20	M4 C'B	8	
TS09L1	9/16"	35	30	5	25	13.8	14.6	20	M4 C'B	8	

As all sizes are for reference, they can be changed without any notification.

2 Line

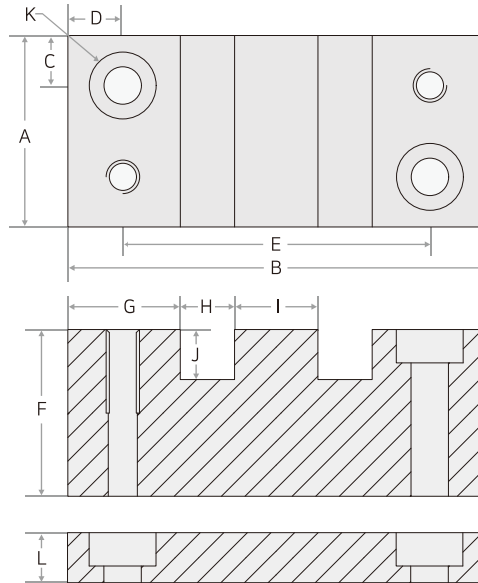
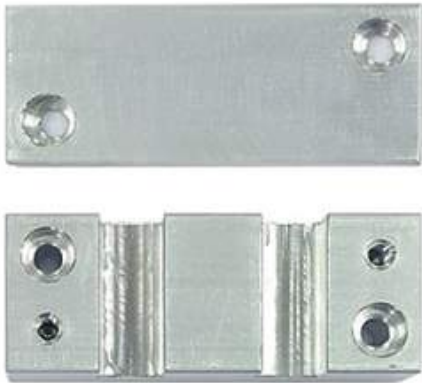

(Unit:mm)

Catalog No.	Tube Size	Dimensions											
		A	B	C	D	E	F	G	H	I	J	K	L
TS04L2	1/4"	25	50	6	6.6	36.8	20	13.5	6.5	5	6	M4 C'B	6
TS06L2	3/8"	25	65	6	6.6	51.8	20	13.5	9.7	18.6	9	M4 C'B	6
TS08L2	1/2"	25	65	6	6.6	51.8	20	13.5	12.7	12.6	12	M4 C'B	6
TS09L2	9/16"	25	65	6	6.6	51.8	20	13.5	14.5	9	14	M4 C'B	6

As all sizes are for reference, they can be changed without any notification.

3 Line

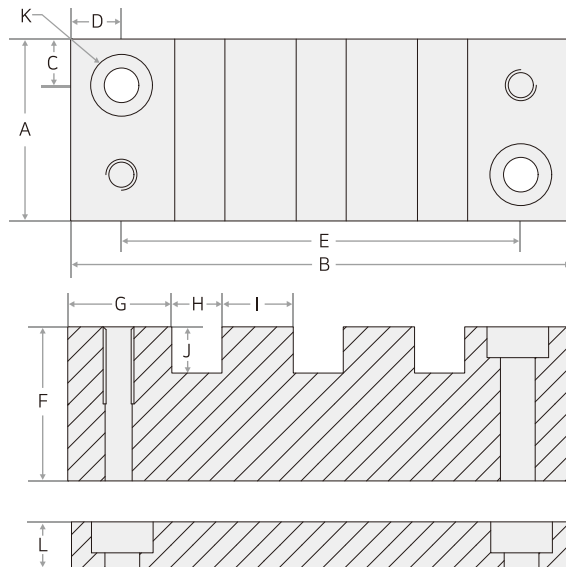

(Unit:mm)

Catalog No.	Tube Size	Dimensions											
		A	B	C	D	E	F	G	H	I	J	K	L
TS04L3	1/4"	25	65	6	6.6	51.8	20	13.5	6.5	9.25	6	M4 C'B	6
TS06L3	3/8"	25	90	6	6.6	76.8	20	13.5	9.7	16.95	9	M4 C'B	6
TS08L3	1/2"	25	90	6	6.6	76.8	20	13.5	12.7	12.45	12	M4 C'B	6
TS09L3	9/16"	25	90	6	6.6	76.8	20	13.5	14.5	9.75	14	M4 C'B	6

As all sizes are for reference, they can be changed without any notification.

High Pressure Union & Adapter

Adapter facilitates pressure and size compatibility without coupling

Female → Female (Union)

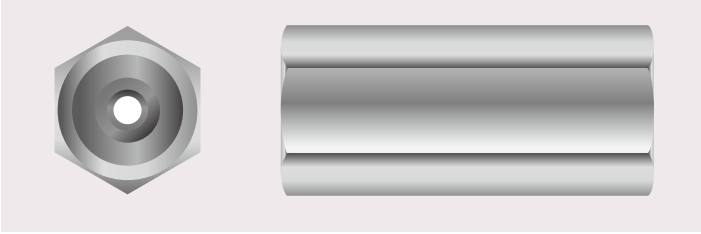

male → Female

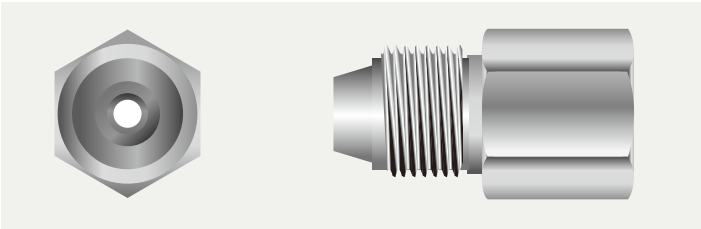

male → male

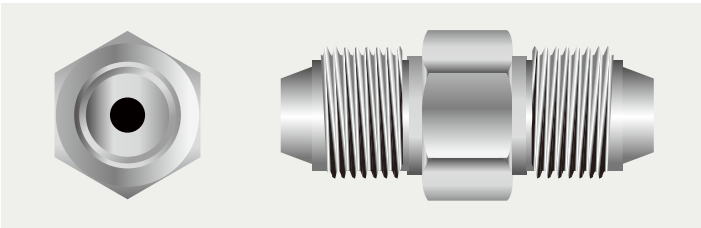

Features

- Using stainless steel 316 cold material for excellent corrosion resistant.
- Various formations from overall pressure to national pipe thread (NPT).
- Cone and thread connection to prevent gas or liquid leaking.
- Glands, Collars or Sleeves are provided for the high pressure part of the female port and you should inquire with us about anti-vibration prevention.
- The cone and thread connection type adapter ensures that products are connected safely and can be used for both fluid and gas in high pressure conditions without causing water leaks.



Female → Female (Union)

		FEMALE END																					
		11,500psi				20,000psi				30,000psi		60,000psi			NPT (National Pipe Thread)								
		1/8"	1/4"	3/8"	1/2"	1/4"	3/8"	9/16"	3/4"	1"	1/8"	1"	1/4"	3/8"	9/16"	1/8"	1/4"	3/8"	1/2"	3/4"	1"		
FEMALE END	11,500psi	1/8"	A011F2/011F2	A011F2/011F4	A011F2/011F6	A011F2/011F8	A011F2/020F4	A011F2/020F6	A011F2/020F9	/	/	A011F2/030F2	/	A011F2/060F4	A011F2/060F6	A011F2/060F9	A011F2/NPTF2	A011F2/NPTF4	A011F2/NPTF6	A011F2/NPTF8	/	/	
		1/4"	/	A011F4/011F4	A011F4/011F6	A011F4/011F8	A011F4/020F4	A011F4/020F6	A011F4/020F9	A011F4/020F12	/	/	A011F4/030F2	/	A011F4/060F4	A011F4/060F6	A011F4/060F9	A011F4/NPTF2	A011F4/NPTF4	A011F4/NPTF6	A011F4/NPTF8	A011F4/NPTF12	/
		3/8"	/	/	A011F6/011F6	A011F6/011F8	A011F6/020F4	A011F6/020F6	A011F6/020F9	A011F6/020F12	A011F6/020F16	A011F6/030F2	A011F6/060F4	A011F6/060F6	A011F6/060F9	A011F6/NPTF2	A011F6/NPTF4	A011F6/NPTF6	A011F6/NPTF8	A011F6/NPTF12	A011F6/NPTF16	A011F6/NPTF16	/
		1/2"	/	/	/	A011F8/011F8	A011F8/020F4	A011F8/020F6	A011F8/020F9	A011F8/020F12	A011F8/020F16	A011F8/030F2	A011F8/030F16	A011F8/060F4	A011F8/060F6	A011F8/060F9	A011F8/NPTF2	A011F8/NPTF4	A011F8/NPTF6	A011F8/NPTF8	A011F8/NPTF12	A011F8/NPTF16	A011F8/NPTF16
	20,000psi	1/4"	/	/	/	A020F4/020F4	A020F4/020F6	A020F4/020F9	A020F4/020F12	A020F4/020F16	A020F4/030F2	/	/	A020F4/060F4	A020F4/060F6	A020F4/060F9	A020F4/NPTF2	A020F4/NPTF4	A020F4/NPTF6	A020F4/NPTF8	A020F4/NPTF12	A020F4/NPTF16	/
		3/8"	/	/	/	/	A020F6/020F6	A020F6/020F9	A020F6/020F12	A020F6/020F16	A020F6/030F2	A020F6/030F16	A020F6/060F4	A020F6/060F6	A020F6/060F9	A020F6/NPTF2	A020F6/NPTF4	A020F6/NPTF6	A020F6/NPTF8	A020F6/NPTF12	A020F6/NPTF16	A020F6/NPTF16	/
		9/16"	/	/	/	/	/	A020F9/020F9	A020F9/020F12	A020F9/020F16	A020F9/030F2	A020F9/030F16	A020F9/060F4	A020F9/060F6	A020F9/060F9	A020F9/NPTF2	A020F9/NPTF4	A020F9/NPTF6	A020F9/NPTF8	A020F9/NPTF12	A020F9/NPTF16	A020F9/NPTF16	/
		3/4"	/	/	/	/	/	/	A020F12/020F12	A020F12/020F16	A020F12/030F2	A020F12/030F16	A020F12/060F4	A020F12/060F6	A020F12/060F9	/	/	/	A020F12/NPTF4	A020F12/NPTF6	A020F12/NPTF8	A020F12/NPTF12	A020F12/NPTF16
	30,000psi	1/8"	/	/	/	/	/	/	/	/	/	A030F2/030F2	/	/	/	/	A030F2/NPTF2	A030F2/NPTF4	A030F2/NPTF6	A030F2/NPTF8	A030F2/NPTF12	A030F2/NPTF16	/
		1"	/	/	/	/	/	/	/	/	/	/	A030F16/030F16	A030F16/060F4	A030F16/060F6	A030F16/060F9	/	/	/	A030F16/NPTF4	A030F16/NPTF6	A030F16/NPTF8	A030F16/NPTF12
	60,000psi	1/4"	/	/	/	/	/	/	/	/	/	/	/	A060F4/060F4	A060F4/060F6	A060F4/060F9	/	/	/	A060F4/NPTF4	A060F4/NPTF6	A060F4/NPTF8	A060F4/NPTF12
		3/8"	/	/	/	/	/	/	/	/	/	/	/	/	A060F6/060F6	A060F6/060F9	/	/	/	A060F6/NPTF4	A060F6/NPTF6	A060F6/NPTF8	A060F6/NPTF12
9/16"		/	/	/	/	/	/	/	/	/	/	/	/	/	A060F9/060F9	/	/	/	A060F9/NPTF2	A060F9/NPTF4	A060F9/NPTF6	A060F9/NPTF8	

(Unit:mm)

		Dimensions																																								
		11,500psi				20,000psi				30,000psi		60,000psi			NPT (National Pipe Thread)																											
		A	B	A	B	A	B	A	B	A	B	A	B	A	B	A	B	A	B	A	B	A	B	A	B	A	B															
11,500psi	1/8"	12.7	31	16	36.5	19	38	25.4	41.5	16	35	19	38	25.4	44.5	/	/	20	31	/	/	19	31.5	25.4	38	36	44.5	16	35	19	38	25.4	41	30	50.5	/	/					
	1/4"	/	/	16	41.5	19	43	25.4	47.5	16	41.5	19	44.5	25.4	50.5	36	57	/	/	20	38	/	/	19	38	25.4	43	36	52	16	38	19	41.5	25.4	44.5	30	54	36	55.5	/	/	
	3/8"	/	/	/	/	19	44.5	25.4	47.5	19	41.5	19	44.5	25.4	50.5	36	57	46	76	20	38	46	76	19	41.5	25.4	46	36	51	19	41.5	19	44.5	25.4	48	30	54	36	58.5	46	68	
	1/2"	/	/	/	/	/	/	25.4	50.5	25.4	41.5	25.4	47.5	25.4	50.5	36	57	46	76	25.4	43	46	76	25.4	43	25.4	47.5	36	52	25.4	38	25.4	50.5	25.4	50.5	30	57	36	63.5	46	72	
20,000psi	1/4"	/	/	/	/	/	/	/	/	16	41.5	19	44.5	25.4	50.5	36	57	46	70	20	38	/	/	19	35	25.4	41.5	36	47.5	16	35	19	41.5	25.4	41.5	30	50.5	36	57	/	/	
	3/8"	/	/	/	/	/	/	/	/	/	/	19	44.5	25.4	50.5	36	57	46	73	20	40	46	76	19	41.5	25.4	50.5	36	50.5	19	38	19	44.5	25.4	46	30	54	36	57	46	66.5	
	9/16"	/	/	/	/	/	/	/	/	/	/	/	25.4	54	36	63.5	46	76	25.4	48	46	76	25.4	48	46	76	25.4	50.5	36	57	25.4	41.5	25.4	50.5	25.4	50.5	30	57	36	57	46	66.5
	3/4"	/	/	/	/	/	/	/	/	/	/	/	/	36	63.5	46	76	36	53.5	46	76	36	53.5	36	60	36	70	/	/	36	54.5	36	60	36	66.5	36	66.5	36	66.5	46	73	
30,000psi	1"	/	/	/	/	/	/	/	/	/	/	/	/	/	/	/	46	89	/	/	46	91	46	70	46	73	46	82.5	/	/	46	67	46	67	46	73	46	76	46	83		
	1/8"	/	/	/	/	/	/	/	/	/	/	/	/	/	/	/	/	20	31	/	/	20	31	25.4	38	36	44.5	20	31	20	36	25.4	41	30	45.5	/	/	/	/	/		
60,000psi	1/4"	/	/	/	/	/	/	/	/	/	/	/	/	/	/	/	/	/	/	46	91	46	68	46	73	46	78	/	/	46	71	46	71	46	76	46	80	46	87			
	3/8"	/	/	/	/	/	/	/	/	/	/	/	/	/	/	/	/	/	/	/	/	/	/	25.4	44.5	36	57	25.4	41.5	25.4	47.5	25.4	47.5	30	54	36	58.5	46	65.5			
	9/16"	/	/	/	/	/	/	/	/	/	/	/	/	/	/	/	/	/	/	/	/	/	/	/	36	57	36	46	36	50.5	36	50.5	36	56.5	36	60	46	68				

As all sizes are for reference, they can be changed without any notification.

How to use the table and order

- Choose the male which is suitable for the pressure and tube size. (Vertical lines of the table)
- Choose the male after confirming the pressure to be connected and the tube size. (Horizontal lines of the table)
- Confirm the relevant catalog numbers and sizes.

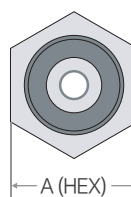

male → Female

		FEMALE END																					
		11,500psi				20,000psi				30,000psi		60,000psi			NPT (National Pipe Thread)								
		1/8"	1/4"	3/8"	1/2"	1/4"	3/8"	9/16"	3/4"	1"	1/8"	1"	1/4"	3/8"	9/16"	1/8"	1/4"	3/8"	1/2"	3/4"	1"		
MALE END	11,500psi	1/8"	A011M2/011F4	A011M2/011F6	A011M2/011F8	A011M2/020F4	A011M2/020F6	A011M2/020F9			A011M2/030F2		A011M2/060F4	A011M2/060F6	A011M2/060F9	A011M2/NPTF2	A011M2/NPTF4	A011M2/NPTF6	A011M2/NPTF8				
		1/4"	A011M4/011F2	A011M4/011F6	A011M4/011F8	A011M4/020F4	A011M4/020F6	A011M4/020F9	A011M4/020F12			A011M4/030F2		A011M4/060F4	A011M4/060F6	A011M4/060F9	A011M4/NPTF2	A011M4/NPTF4	A011M4/NPTF6	A011M4/NPTF8	A011M4/NPTF12		
		3/8"	A011M6/011F2	A011M6/011F4	A011M6/011F6	A011M6/020F4	A011M6/020F6	A011M6/020F9	A011M6/020F12	A011M6/020F16	A011M6/030F2	A011M6/030F16		A011M6/060F4	A011M6/060F6	A011M6/060F9	A011M6/NPTF2	A011M6/NPTF4	A011M6/NPTF6	A011M6/NPTF8	A011M6/NPTF12	A011M6/NPTF16	
		1/2"	A011M8/011F2	A011M8/011F4	A011M8/011F6	A011M8/011F8	A011M8/020F4	A011M8/020F6	A011M8/020F9	A011M8/020F12	A011M8/020F16	A011M8/030F2	A011M8/030F16		A011M8/060F4	A011M8/060F6	A011M8/060F9	A011M8/NPTF2	A011M8/NPTF4	A011M8/NPTF6	A011M8/NPTF8	A011M8/NPTF12	A011M8/NPTF16
	20,000psi	1/4"	A020M4/011F2	A020M4/011F4	A020M4/011F6	A020M4/011F8		A020M4/020F6	A020M4/020F9	A020M4/020F12	A020M4/020F16	A020M4/030F2	A020M4/030F16	A020M4/060F4	A020M4/060F6	A020M4/060F9	A020M4/NPTF2	A020M4/NPTF4	A020M4/NPTF6	A020M4/NPTF8	A020M4/NPTF12		
		3/8"	A020M6/011F2	A020M6/011F4	A020M6/011F6	A020M6/011F8	A020M6/020F4		A020M6/020F9	A020M6/020F12	A020M6/020F16	A020M6/030F2	A020M6/030F16	A020M6/060F4	A020M6/060F6	A020M6/060F9	A020M6/NPTF2	A020M6/NPTF4	A020M6/NPTF6	A020M6/NPTF8	A020M6/NPTF12	A020M6/NPTF16	
		9/16"	A020M9/011F2	A020M9/011F4	A020M9/011F6	A020M9/011F8	A020M9/020F4	A020M9/020F6		A020M9/020F12	A020M9/020F16	A020M9/030F2	A020M9/030F16	A020M9/060F4	A020M9/060F6	A020M9/060F9	A020M9/NPTF2	A020M9/NPTF4	A020M9/NPTF6	A020M9/NPTF8	A020M9/NPTF12	A020M9/NPTF16	
		3/4"	A020M12/011F2	A020M12/011F4	A020M12/011F6	A020M12/011F8	A020M12/020F4	A020M12/020F6	A020M12/020F9		A020M12/020F16		A020M12/030F16	A020M12/060F4	A020M12/060F6	A020M12/060F9		A020M12/NPTF4	A020M12/NPTF6	A020M12/NPTF8	A020M12/NPTF12	A020M12/NPTF16	
	30,000psi	1"	A030M16/011F4	A030M16/011F6	A030M16/011F8	A030M16/020F4	A030M16/020F6	A030M16/020F9	A030M16/020F12		A030M16/020F16			A030M16/060F4	A030M16/060F6	A030M16/060F9		A030M16/NPTF4	A030M16/NPTF6	A030M16/NPTF8	A030M16/NPTF12	A030M16/NPTF16	
		1 1/2"	A030M18/011F4	A030M18/011F6	A030M18/011F8	A030M18/020F4	A030M18/020F6	A030M18/020F9	A030M18/020F12	A030M18/020F16				A030M18/060F4	A030M18/060F6	A030M18/060F9		A030M18/NPTF4	A030M18/NPTF6	A030M18/NPTF8	A030M18/NPTF12	A030M18/NPTF16	
	60,000psi	1/4"	A060M4/011F2	A060M4/011F4	A060M4/011F6	A060M4/011F8	A060M4/020F4	A060M4/020F6	A060M4/020F9	A060M4/020F12		A060M4/030F2		A060M4/060F4	A060M4/060F6	A060M4/060F9	A060M4/NPTF2	A060M4/NPTF4	A060M4/NPTF6	A060M4/NPTF8	A060M4/NPTF12		
		3/8"	A060M6/011F2	A060M6/011F4	A060M6/011F6	A060M6/011F8	A060M6/020F4	A060M6/020F6	A060M6/020F9	A060M6/020F12	A060M6/020F16	A060M6/030F2	A060M6/030F16	A060M6/060F4		A060M6/060F9	A060M6/NPTF2	A060M6/NPTF4	A060M6/NPTF6	A060M6/NPTF8	A060M6/NPTF12	A060M6/NPTF16	
		9/16"	A060M9/011F2	A060M9/011F4	A060M9/011F6	A060M9/011F8	A060M9/020F4	A060M9/020F6	A060M9/020F9	A060M9/020F12	A060M9/020F16	A060M9/030F2	A060M9/030F16	A060M9/060F4	A060M9/060F6		A060M9/NPTF2	A060M9/NPTF4	A060M9/NPTF6	A060M9/NPTF8	A060M9/NPTF12	A060M9/NPTF16	
	NPT	1/8"	ANPTM2/011F2	ANPTM2/011F4	ANPTM2/011F6	ANPTM2/011F8	ANPTM2/020F4	ANPTM2/020F6	ANPTM2/020F9			ANPTM2/030F2		ANPTM2/060F4	ANPTM2/060F6	ANPTM2/060F9		ANPTM2/NPTF4	ANPTM2/NPTF6	ANPTM2/NPTF8	ANPTM2/NPTF12		
		1/4"	ANPTM4/011F2	ANPTM4/011F4	ANPTM4/011F6	ANPTM4/011F8	ANPTM4/020F4	ANPTM4/020F6	ANPTM4/020F9	ANPTM4/020F12	ANPTM4/020F16	ANPTM4/030F2	ANPTM4/030F16	ANPTM4/060F4	ANPTM4/060F6	ANPTM4/060F9		ANPTM4/NPTF4	ANPTM4/NPTF6	ANPTM4/NPTF8	ANPTM4/NPTF12		
		3/8"	ANPTM6/011F2	ANPTM6/011F4	ANPTM6/011F6	ANPTM6/011F8	ANPTM6/020F4	ANPTM6/020F6	ANPTM6/020F9	ANPTM6/020F12	ANPTM6/020F16	ANPTM6/030F2	ANPTM6/030F16	ANPTM6/060F4	ANPTM6/060F6	ANPTM6/060F9		ANPTM6/NPTF4	ANPTM6/NPTF6	ANPTM6/NPTF8	ANPTM6/NPTF12		
		1/2"	ANPTM8/011F2	ANPTM8/011F4	ANPTM8/011F6	ANPTM8/011F8	ANPTM8/020F4	ANPTM8/020F6	ANPTM8/020F9	ANPTM8/020F12	ANPTM8/020F16	ANPTM8/030F2	ANPTM8/030F16	ANPTM8/060F4	ANPTM8/060F6	ANPTM8/060F9		ANPTM8/NPTF4	ANPTM8/NPTF6	ANPTM8/NPTF8	ANPTM8/NPTF12		
		3/4"		ANPTM12/011F4	ANPTM12/011F6	ANPTM12/011F8	ANPTM12/020F4	ANPTM12/020F6	ANPTM12/020F9	ANPTM12/020F12	ANPTM12/020F16	ANPTM12/030F2	ANPTM12/030F16	ANPTM12/060F4	ANPTM12/060F6	ANPTM12/060F9	ANPTM12/NPTF2		ANPTM12/NPTF4	ANPTM12/NPTF6	ANPTM12/NPTF8	ANPTM12/NPTF12	
		1"			ANPTM16/011F6	ANPTM16/011F8		ANPTM16/020F6	ANPTM16/020F9	ANPTM16/020F12	ANPTM16/020F16		ANPTM16/030F16		ANPTM16/060F4	ANPTM16/060F6	ANPTM16/060F9		ANPTM16/NPTF4	ANPTM16/NPTF6	ANPTM16/NPTF8	ANPTM16/NPTF12	

(Unit:mm)

		Dimensions																																						
		11,500psi				20,000psi				30,000psi		60,000psi			NPT (National Pipe Thread)																									
		A	B	A	B	A	B	A	B	A	B	A	B	A	B	A	B	A	B	A	B																			
11,500psi	1/8"	16	32	19	35	25.4	38	16	32	19	35	25.4	42		20	27	19	29	25.4	34	36	40	16	28	19	34	25.4	38	30	43										
	1/4"	16	27.5			19	41.5	25.4	44.5	16	35	19	42.5	25.4	48	36	57.5			19	32.5	25.4	39.5	36	45.5	16	33	19	37	25.4	43	30	47.5	36	55.5					
	3/8"	19	30	19	35		25.4	45			19	35	19	40	25.4	48	36	57.5	46	70	20	35	46	70	19	35	19	37	25.4	43	30	50	36	57.5	46	70				
	1/2"	25.4	33	25.4	33	25.4	37			25.4	37	25.4	40	25.4	48	36	57.5	46	70	25.4	37	46	70	25.4	35	25.4	42	36	45.5	25.4	35	25.4	43	30	50	36	57.5	46	70	
20,000psi	1/4"	16	34	16	40	19	40	25.4	43			19	40	25.4	50	36	57.5	46	70	20	37	46	70	19	32	25.4	42	36	45.5	16	33	19	37	25.4	43	30	50	36	57.5	
	3/8"	16	34	16	40	19	44	25.4	48	16	36		25.4	52	36	57.5	46	72	20	37	46	72	19	36.5	25.4	42	36	47	16	34	19	39.5	25.4	45	30	50	36	57.5	46	70
	9/16"	22	40	22	44	22	45	25.4	49	24	40	24	46		36	62.5	46	75	22	40	46	75	22	40	25.4	47	36	52	22	40	22	43	25.4	47	30	54	36	62	46	73
	3/4"			30	46	30	50	30	56	30	48	30	52	30	57		46	80			46	80	30	48	30	52	36	58			30	48	30	52	30	56	36	68	46	78
30,000psi	1/8"	16	29	16	34	19	37	25.4	40	16	31	19	37	25.4	44								19	30	25.4	36	36	46	16	29	19	36	25.4	39	30	43				
	1"			36	55	36	55	36	55	36	57	36	60	36	64	36	70	46	82					36	55	36	61	36	65			36	61	36	61	36	61	36	69	46
60,000psi	1/4"	16	30	16	35	19	38	25.4	42	16	32	19	40	25.4	46	36	55			20	32				25.4	48.5	36	49.5	16	30	19	36	25.4	42	30	46	36	53		
	3/8"	20	35.5	20	41.5	20	42.5	25.4	44.5	20	42.5	20	43.5	25.4	50.5	36	57.5	46	74.5	20	35.5	46	74.5	20	44.5		36	50.5	20	35.5	20	40.5	25.4	45.5	30	52.5	36	58.5	46	65.5
	9/16"	30	38	30	42.5	30	42.5	30	44.5	30	42.5	30	46	30	51	36	61	46	78	30	38	46	78	30	44	30	47		30	38	30	41	30	49	30	54	36	59	46	70
NPT	1/8"	12.7	25	16	31	19	36	25.4	38	16	28	19	36	25.4	42							20	25	19	28	25.4	36	36	41											
	1/4"	16	28	16	35	19	38	25.4	41	16	33	19	36	25.4	44	36	52	46	68	20	30	46	68	19	33	25.4	38	36	43						30	47				
	3/8"	19	30	19	35	19	38	25.4	42	19	35	19	38	25.4	42	36	52	46	68	20	30	46	68	19	33	25.4	38	36	44							30	47			
	1/2"	25.4	37	25.4	41	25.4	43	25.4	47	25.4	37	25.4	43	25.4	47	36	52	46	68	25.4	37	46	68	25.4	37	25.4	43	36	47								36	57		
	3/4"			30	44.5	30</																																		

■ male → male

	MALE END	MALE END																			
		11,500psi				20,000psi				30,000psi		60,000psi			NPT (National Pipe Thread)						
		1/8"	1/4"	3/8"	1/2"	1/4"	3/8"	9/16"	3/4"	1"	1/8"	1"	1/4"	3/8"	9/16"	1/8"	1/4"	3/8"	1/2"	3/4"	1"
11,500psi	1/8"	A011M2/011M2	A011M2/011M4	A011M2/011M6	A011M2/011M8	A011M2/020M4	A011M2/020M6	A011M2/020M9			A011M2/030M2		A011M2/060M4	A011M2/060M6	A011M2/060M9	A011M2/NPTM2	A011M2/NPTM4	A011M2/NPTM6	A011M2/NPTM8		
	1/4"		A011M4/011M4	A011M4/011M6	A011M4/011M8	A011M4/020M4	A011M4/020M6	A011M4/020M9	A011M4/020M12		A011M4/030M2		A011M4/060M4	A011M4/060M6	A011M4/060M9	A011M4/NPTM2	A011M4/NPTM4	A011M4/NPTM6	A011M4/NPTM8	A011M4/NPTM12	
	3/8"			A011M6/011M6	A011M6/011M8	A011M6/020M4	A011M6/020M6	A011M6/020M9	A011M6/020M12	A011M6/020M16	A011M6/030M2	A011M6/030M16	A011M6/060M4	A011M6/060M6	A011M6/060M9	A011M6/NPTM2	A011M6/NPTM4	A011M6/NPTM6	A011M6/NPTM8	A011M6/NPTM12	A011M6/NPTM16
	1/2"				A011M8/011M8	A011M8/020M4	A011M8/020M6	A011M8/020M9	A011M8/020M12	A011M8/020M16	A011M8/030M2	A011M8/030M16	A011M8/060M4	A011M8/060M6	A011M8/060M9	A011M8/NPTM2	A011M8/NPTM4	A011M8/NPTM6	A011M8/NPTM8	A011M8/NPTM12	A011M8/NPTM16
20,000psi	1/4"					A020M4/020M4	A020M4/020M6	A020M4/020M9	A020M4/020M12	A020M4/020M16	A020M4/030M2		A020M4/060M4	A020M4/060M6	A020M4/060M9	A020M4/NPTM2	A020M4/NPTM4	A020M4/NPTM6	A020M4/NPTM8	A020M4/NPTM12	A020M4/NPTM16
	3/8"						A020M6/020M6	A020M6/020M9	A020M6/020M12	A020M6/020M16	A020M6/030M2	A020M6/030M16	A020M6/060M4	A020M6/060M6	A020M6/060M9	A020M6/NPTM2	A020M6/NPTM4	A020M6/NPTM6	A020M6/NPTM8	A020M6/NPTM12	A020M6/NPTM16
	9/16"							A020M9/020M9	A020M9/020M12	A020M9/020M16	A020M9/030M2	A020M9/030M16	A020M9/060M4	A020M9/060M6	A020M9/060M9	A020M9/NPTM2	A020M9/NPTM4	A020M9/NPTM6	A020M9/NPTM8	A020M9/NPTM12	A020M9/NPTM16
	3/4"								A020M12/020M12	A020M12/020M16	A020M12/030M2	A020M12/030M16	A020M12/060M4	A020M12/060M6	A020M12/060M9		A020M12/NPTM4	A020M12/NPTM6	A020M12/NPTM8	A020M12/NPTM12	A020M12/NPTM16
	1"									A020M16/020M16		A020M16/030M16	A020M16/060M4	A020M16/060M6	A020M16/060M9		A020M16/NPTM4	A020M16/NPTM6	A020M16/NPTM8	A020M16/NPTM12	A020M16/NPTM16
30,000psi	1/8"										A030M2/030M2		A030M2/060M4	A030M2/060M6	A030M2/060M9	A030M2/NPTM2	A030M2/NPTM4	A030M2/NPTM6	A030M2/NPTM8		
	1"											A030M16/030M16	A030M16/060M4	A030M16/060M6	A030M16/060M9		A030M16/NPTM4	A030M16/NPTM6	A030M16/NPTM8	A030M16/NPTM12	A030M16/NPTM16
60,000psi	1/4"												A060M4/060M4	A060M4/060M6	A060M4/060M9	A060M4/NPTM2	A060M4/NPTM4	A060M4/NPTM6	A060M4/NPTM8	A060M4/NPTM12	
	3/8"													A060M6/060M6	A060M6/060M9	A060M6/NPTM2	A060M6/NPTM4	A060M6/NPTM6	A060M6/NPTM8	A060M6/NPTM12	A060M6/NPTM16
	9/16"														A060M9/060M9	A060M9/NPTM2	A060M9/NPTM4	A060M9/NPTM6	A060M9/NPTM8	A060M9/NPTM12	A060M9/NPTM16
NPT	1/8"															ANPTM2/NPTM2	ANPTM2/NPTM4	ANPTM2/NPTM6	ANPTM2/NPTM8		
	1/4"																ANPTM4/NPTM4	ANPTM4/NPTM6	ANPTM4/NPTM8	ANPTM4/NPTM12	
	3/8"																	ANPTM6/NPTM6	ANPTM6/NPTM8	ANPTM6/NPTM12	ANPTM6/NPTM16
	1/2"																		ANPTM8/NPTM8	ANPTM8/NPTM12	ANPTM8/NPTM16
	3/4"																			ANPTM12/NPTM12	ANPTM12/NPTM16
1"																				ANPTM16/NPTM16	

(Unit:mm)

	Dimensions	Dimensions																																											
		11,500psi								20,000psi								30,000psi				60,000psi						NPT (National Pipe Thread)																	
		A	B	A	B	A	B	A	B	A	B	A	B	A	B	A	B	A	B	A	B	A	B	A	B	A	B	A	B	A	B	A	B	A	B	A	B								
11,500psi	1/8"	12.7	35	16	41	19	46.5	25.4	49.5	14	39.5	16	43.5	25.4	49.5					14	36.5			16	41	25.4	50	30	54.5	12.7	34.5	16	41.5	19	44.5	25.4	49.5								
	1/4"			16	47	19	51.5	25.4	54.5	16	44.5	16	48.5	25.4	56.5	30	65					14	41.5			16	46	25.4	55	30	59.5	16	39.5	16	44.5	19	47.5	25.4	54.5	30	57.5				
	3/8"					19	54	25.4	57	19	47	19	51	25.4	59	30	67.5	36	77.5	19	44	36	78.5	19	48.5	25.4	57.5	30	62	19	42	19	47	19	50	25.4	57	30	60	36	60				
	1/2"						25.4	57.5	25.4	54	25.4	58	25.4	62	30	70	36	80	25.4	51	36	81	25.4	51.5	25.4	60	30	64.5	25.4	44.5	25.4	47.5	25.4	50.5	25.4	57.5	30	60.5	36	66.5					
20,000psi	1/4"									12.7	44	16	48	25.4	56	30	64.5	36	78.5	14	41			16	45.5	20	54.5	30	61	12.7	41	16	44	19	46	25.4	54	30	59						
	3/8"											16	54	25.4	60	30	70	36	84.5	16	45	36	85.5	16	49.5	20	58.5	30	65	16	45	16	49	19	50	25.4	58	30	63	36	69				
	9/16"													25.4	64	30	76	36	91	25.4	53	36	92	22	56	22	62.5	30	69	22	50.5	22	55	22	54	25.4	62	30	67	36	73				
	3/4"														30	82	36	97	30	65	36	98	30	62	30	70.5	30	75			30	63	30	64	30	68	30	73	36	79					
	1"															36	107			36	108			36	76.5	36	82.5	36	88			36	80	36	81	36	84	36	85	36	89				
30,000psi	1/8"																						14	38			16	42.5	20	51.5	30	58	14	36	14	41	19	46	25.4	51					
	1"																							36	109			36	81.5	36	87.5	36	91			36	79	36	80	36	83	36	84	36	88
	1/4"																										16	43	20	52	30	58.5	16	41.5	16	44.5	19	46.5	25.4	51.5	30	56.5			
60,000psi	3/8"																											20	58	30	64.5	20	47.5	20	50.5	20	52.5	25.4	57.5	30	62.5	36	68.5		
	9/16"																												30	68	30	53	30	56	30	57	30	61	30	66	36	72			
NPT	1/8"																															12.7	33	16	39	20	42	25.4	46						
	1/4"																																16	42	20	45	25.4	49	30	54					
	3/8"																																		20	46	25.4	50	30	55	36	61			
	1/2"																																					25.4	57	30	58	36	64		
	3/4"																																							30	59	36	65		
1"																																								36	69				

As all sizes are for reference, they can be changed without any notification.

Regulator

High pressure & Back pressure regulator series



The regulator is a pressure control device designed to maintain pressure by controlling the pressure being released to the outlet within the range of the pressure coming into the inlet. The regulator is divided into GPR for low pressure and HPR for high pressure and BPR for back pressure, so you can use this product according to the pressure options you want.

It is based on a contrary concept to the regulator that is generally used. Unlike the pressure regulator which is widely used to control the pressure of the outlet, the BPR steadily maintains the inlet pressure which you need.

Product	GPR (General Pressure Regulator)	HPR (High Pressure Regulator)	BPR (Back Pressure Regulator)
Photos			
Maximum rated inlet pressure	3,500 psi	15,000 psi	15,000 psi
Max working pressure. (Product series)	500 psi 1,000 psi 1,500 psi	2,000 psi 4,000 psi 6,000 psi	2,000 psi 4,000 psi 6,000 psi
Maximum temperature	-40°C~100°C	-55°C~100°C	-55°C~100°C

Pressure Gauge

Versatile pressure gauge for precise measurement

A Type - 60mm / 100mm



J Type - 60mm/100mm



TECSIS A Type - 60mm/100mm



TECSIS J Type - 60mm/100mm



Features

- Easy to install and assemble.
- High corrosion resistance for environment.
- Stainless steel material.
- Suitable to use under the high mechanical vibration environment.
- Better performance and high durability.
- Possible to vibration suppression with using oil.
- Can be applied to various industries in high pressure.

Catalog No. & Pressure Range	Bottom Connection Direct		Back Connection Flush	
		HI60A4c-20	0~20kgf/cm ²	HI60J4c-35
	HI60A4c-50	0~50kgf/cm ²	HI100J3d-100	0~100kgf/cm ²
	HI60A4c-150	0~150kgf/cm ²	HI100J3d-250	0~250kgf/cm ²
	HI60A4c-250	0~250kgf/cm ²	HI100J3d-500	0~500kgf/cm ²
	HI100A3d-500	0~500kgf/cm ²	HI100J3d-1000	0~1000kgf/cm ²
	HI100A3d-1000	0~1000kgf/cm ²		
Size	60mm	100mm	60mm	100mm
Connection	NPT 1/4"	PF 3/8"	NPT 1/4"	PF 3/8"
Type	A Type		J Type	
Accuracy	±1.5%			
Temperature	with glycerin : -5 ~ 55°C with silicone oil : -25 ~ 55°C No oil filled : -40 ~ 200°C			
Case	304SS			
Cover	Whole-Steel			
Movement	304SS			
Pointer	Black Aluminum			
Element & Socket	Organic Glass		Flat Glass	
Window	Black Electrophoresis Manganese Steel Belt			
Ductility	-0.1 ~ 0.06MPa ~ -0.1 ~ 2.4Mpa			
Vacuum	-0.1MPa ~ 0			



Lok Fitting & Valve

It can be applied to various process and system configuration of the whole industry such as plant industry, chemical, water jet, oil, gas, etc

Lok Type Valve

				
Needle Valve NVP1	Needle Valve NVS1	Check Valve CV1	Ball Valve HBV1	Ball Valve HBV10
				
Ball Valve HBV10-NF	Ball Valve BV1	Ball Valve BV3	LF Coaxial Filter	

Lok Type Fitting

					
Tee	Elbow	Cross	Front Ferrule	Back Ferrule	Plug
					
Bulkhead Union	Union Fitting	Reducing Union	Reducer	Male Connector	Female Connector
					
Male Adapter	Female Adapter	Nut	Port Connector	Cap	AN Union

It can be applied to various process and system configuration of the whole industry such as plant industry, chemical, water jet, oil, gas, etc

Low Pressure Piping Materials

				
Stainless Screw Gate Valve	Stainless Screw Fitting 90° Elbow	Butt Welding Fitting Tee (S10)	One-Touch Fitting PW	Flange 10kg SLIP-ON SOFF
				
Non-Welding Fitting Copper Loflink Coupling	VCR Fitting Male Weld Gland	Pipe Fitting Hex Coupling (HC)	Cam Lock Coupler A Type	Solenoid Valve 2way HPW

Sanitary Valve & fitting

				
Sanitary Ball Valve 2 Ferrule	Sanitary Butterfly Valve 2 Ferrule	Sanitary Weld Tee	Sanitary Ferrule Clamp	Sanitary Ferrule

Pressure / Temperature / Flow Meter

				
Compact Size Pressure Transmitter M5200	Pressure Sensor PSH (0, 15%)	Thermocouple JK-1020 Head Type	Thermowell JW-1012	Parker SUS Flexible Hose
				
Differential Pressure Transmitters DPD (0,5%)	Digital Gauge/ Switch SSD (0,25% & 0,5%)	Digital Pressure Gauge PDR100 (0,5%)	Digital Indicator A1-1000 V, mA	Quick level switch SMQ-600

Port Type

Low Pressure Port Type

Sleeve Type Connections - 11,500 psi

Sleeve Type can be used in 1/8", 1/4", 3/8", 1/2" piping by fastening sleeve in gland.

Tube required for connection between products can be ordered from Hiflux. Stainless steel material ensures optimum performance in high pressure environment.

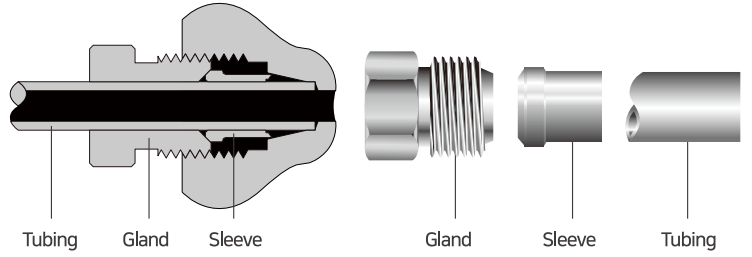

H508 5,500psi - 1/2"	H706 7,500psi - 3/8"	H1104 11,500psi - 1/4"	H1102 11,000psi - 1/8"

Port Type

Medium Pressure Port Type

Medium Pressure Connections - 20,000 psi

The Nipple required for connection between the products by using Collar and Nipple in the Gland can be ordered by user's desired length, you can also process directly using our Tooling Set tool.

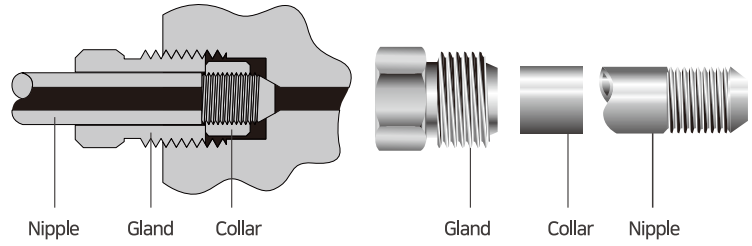

H2004 20,000psi - 1/4"	H2006 20,000psi - 3/8"	H2009 20,000psi - 9/16"	H2012 20,000psi - 3/4"	H2016 20,000psi - 1"
<p>7/16"-20 12.7 60° Ø4.8 Ø2.8</p>	<p>9/16"-18 15.8 Ø7.9 Ø5.2</p>	<p>13/16"-16 19 Ø12.8 Ø7.9</p>	<p>3/4"-14 23.9 Ø15.8 Ø11.1</p>	<p>1-3/8"-12 33.3 Ø22.4 Ø14.3</p>
<p>12 HEX 16</p>	<p>16 HEX 20</p>	<p>22 HEX 27</p>	<p>27 HEX 28</p>	<p>36 HEX 38</p>
<p>Ø9.5 5.5 1/4"-28 LH</p>	<p>Ø11.9 6.4 3/8"-24 LH</p>	<p>Ø18.3 8 9/16"-18 LH</p>	<p>Ø23.8 9.5 3/4"-16 LH</p>	<p>Ø31 12.5 1"-14 LH</p>
<p>Ø6.35 26.5 Ø9.3 Ø3.57</p>	<p>Ø9.53 32 Ø11.7 Ø6.35</p>	<p>Ø14.29 42 Ø18.1 Ø10.32</p>	<p>Ø19.05 45.5 Ø23.6 Ø14.29</p>	<p>Ø25.4 60 Ø30.7 Ø18.26</p>
<p>1/4"-28 LH 9 Ø3.57 Ø2.77</p>	<p>3/8"-24 LH 11 Ø6.35 Ø5.16</p>	<p>9/16"-18 LH 13 Ø10.32 Ø7.92</p>	<p>3/4"-16 LH 16 Ø14.29 Ø11.12</p>	<p>1"-14 LH 20 Ø18.26 Ø14.27</p>

Port Type

High Pressure Port Type

High Pressure Connections - 30,000 psi / 60,000 psi

The Nipple required for connection between the products by using Collar and Nipple in the Gland can be ordered by user's desired length, you can also process directly using our Tooling Set tool. This cone and threaded connection is the standard for easy and fast high-pressure equipment configuration with optimum sealing and reliable performance for both liquid and gas at high pressure and temperature.

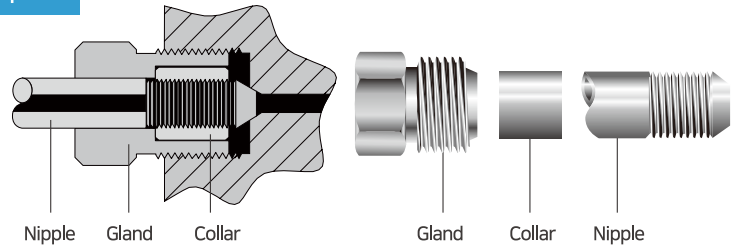

H3002 30,000psi - 1/8"	H3016 30,000psi - 1"	H6004 60,000psi - 1/4" (M : Metric)	H6006 60,000psi - 3/8" (M : Metric)	H6009 60,000psi - 9/16" (M : Metric)
<p>1/2"-20 60° 11.37 Ø1.16 Ø2.4</p>	<p>1-3/8"-12 33.3 Ø22.4 Ø11.1</p>	<p>9/16"-18 (M16x1.5P) 11(11.5) Ø4.3(Ø5) Ø2.4(Ø2.4)</p>	<p>3/4"-16 (M20x1.5P) 16(15) Ø6.6 Ø3.2(Ø3.2)</p>	<p>1-1/8"-12 (M26x1.5P) 19(15) Ø9.7 Ø4.8</p>
<p>13 HEX 18</p>	<p>36 HEX 38</p>	<p>16 HEX(17HEX) 20(22)</p>	<p>20 HEX(22HEX) 30(30)</p>	<p>30 HEX(27HEX) 38(38)</p>
<p>Ø3.18 24 Ø6.35 Ø1.78</p>	<p>Ø25.4 62 Ø31.45 Ø15.4</p>	<p>Ø6.3 27.5 Ø9.37 Ø3.18</p>	<p>Ø9.5 37 Ø12.56 Ø5.56</p>	<p>Ø14.4 47 Ø20.7 Ø7.14</p>
<p>1/8"-40 LH 11.12 Ø1.59 Ø1.02</p>	<p>1-14 LH 23 Ø14.3 Ø11.1</p>	<p>1/4"-28 LH 14.3 Ø3.18 Ø2.1</p>	<p>3/8"-24 LH 18.5 Ø5.56 Ø3.18</p>	<p>9/16"-18 LH 24 Ø7.14 Ø4.76</p>
<p>Ø6.3 8 1/8"-40 LH</p>	<p>Ø31.8 12.5 1"-14 LH</p>	<p>Ø9.5 9.5 1/4"-28 LH 8 Ø9.6 Ø6.49</p>	<p>Ø12.7 13.5 3/8"-24 LH 11.5 Ø12.9 Ø9.65</p>	<p>Ø20.7 16 9/16"-18 LH 14.5 Ø20.9 Ø14.4</p>

Port Type

Ultra High Pressure Port Type

Ultra High Pressure Connections - 100,000 psi

The product is tightened with collar and nipple in Gland. The applicable pipe size is as follows. This cone and threaded connection is the standard for easy and fast high-pressure equipment configuration with optimum sealing and reliable performance for both liquid and gas at high pressure and temperature.

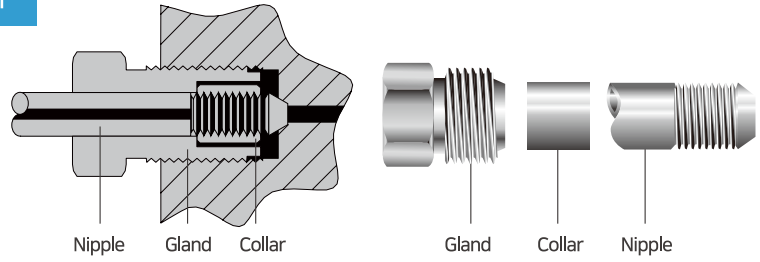

H10004

100,000psi - 1/4"

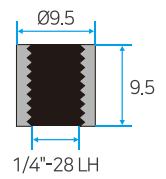
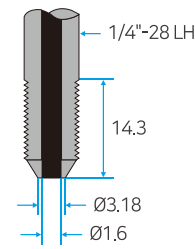
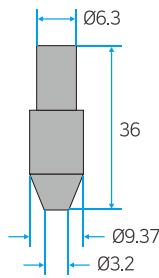
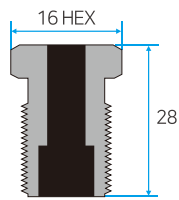
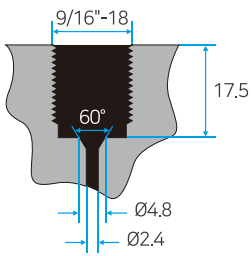

포트타입

Ultra High Pressure Port Type

Ultra High Pressure Connections - 150,000 psi

The product is tightened with collar and nipple in Gland. The applicable pipe size is as follows. This cone and threaded connection is the standard for easy and fast high-pressure equipment configuration with optimum sealing and reliable performance for both liquid and gas at high pressure and temperature.

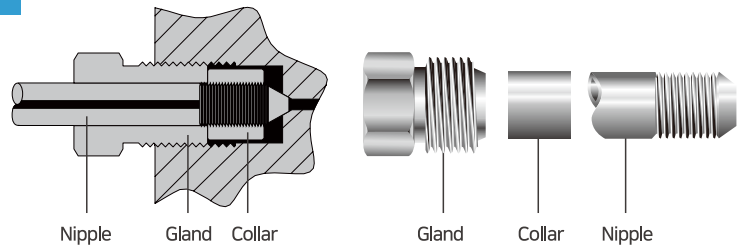

H15006

150,000psi - 3/8"

